

# OVVO® Connection System

## 1240 Permanent Specifications

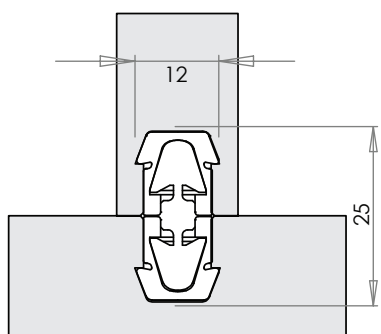

1240 Permanent

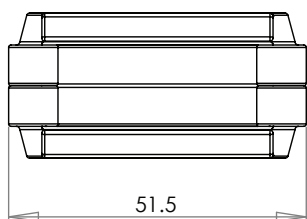
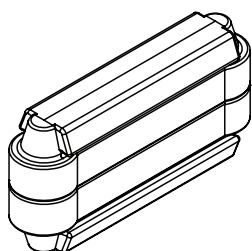

1240PH

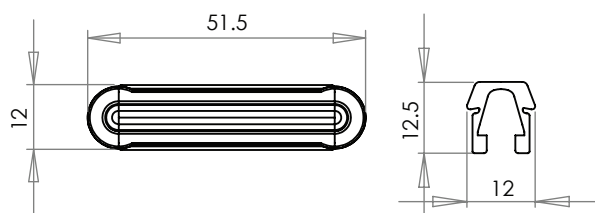

1240PC

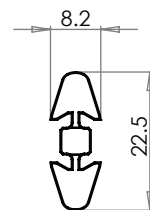
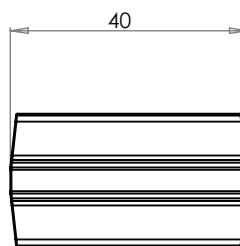
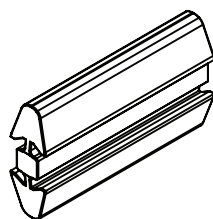

1240PH

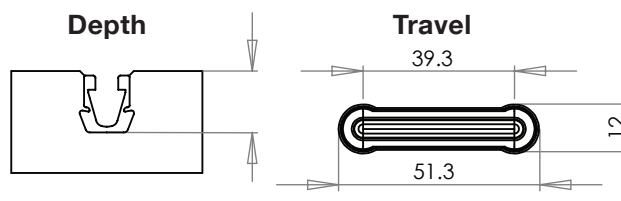
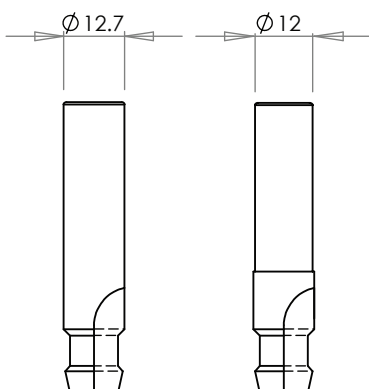
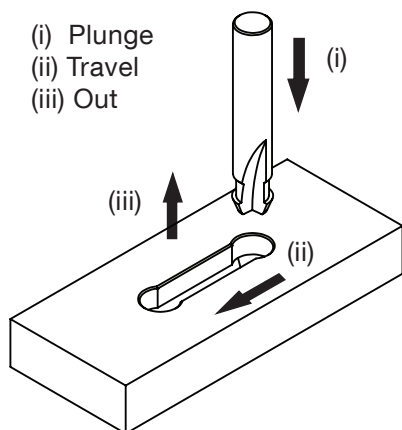
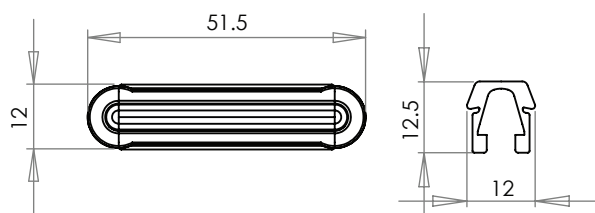

**Depth Tolerances:** 12.9mm, +/- 0.5mm  
**Travel (Centre to Centre):** 39.3mm  
**Out to Out:** 51.3mm

*CNC speeds vary with different materials.  
 Maximum cutter rotation: 18,000*

# 1240 Recommended Minimum Board Depth



Recommended minimum board depth or thickness values for the 1240 will change depending on both the substrate material used as well as the joint angle and axis of connection.

Minimum recommended measurements shown below are categorized according to two distinct groups of board material which share broadly similar connector retention properties.



Fig 1



Fig 2

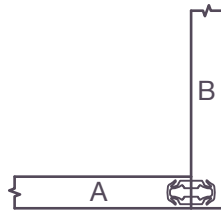

Fig 3

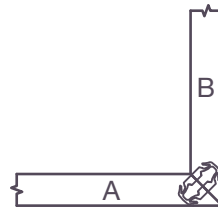

Fig 4

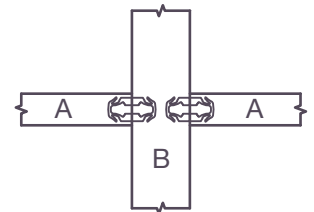

Fig 5

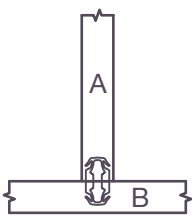

Fig 6

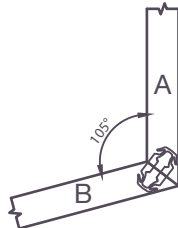

Fig 7

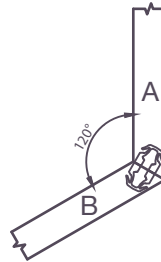

Fig 8

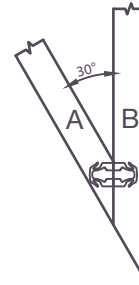

Fig 9

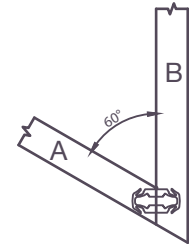

Fig 10

| HPL/Composite, Solid Surface, Hardwoods, Birch Plywood |      |      |
|--|------|------|
|  | A    | B    |
| Fig 1  | 16mm | 16mm |
| Fig 2  | 15mm | 15mm |
| Fig 3  | 18mm | 18mm |
| Fig 4  | 18mm | 18mm |
| Fig 5  | 15mm | 28mm |
| Fig 6  | 18mm | 15mm |
| Fig 7  | 18mm | 18mm |
| Fig 8  | 18mm | 18mm |
| Fig 9  | 18mm | 15mm |
| Fig 10   | 18mm | 15mm |

| Particle/Chipboard, Softwoods/MDF |      |      |
|-----------------------------------|------|------|
|                                   | A    | B    |
| Fig 1                             | 18mm | 18mm |
| Fig 2                             | 15mm | 15mm |
| Fig 3                             | 18mm | 15mm |
| Fig 4                             | 18mm | 18mm |
| Fig 5                             | 18mm | 28mm |
| Fig 6                             | 18mm | 15mm |
| Fig 7                             | 18mm | 18mm |
| Fig 8                             | 18mm | 18mm |
| Fig 9                             | 18mm | 15mm |
| Fig 10                            | 18mm | 15mm |



These are guidelines only and OVVO® recommends trial connections be made before going into full production.

# OVVO® Permanent 1240

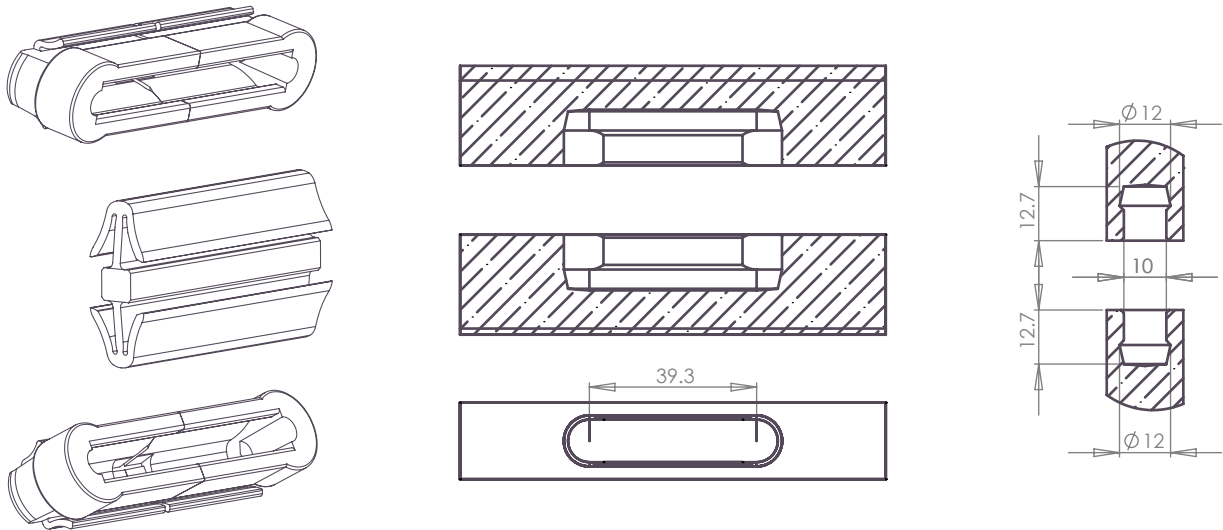
## Shear & Tensile

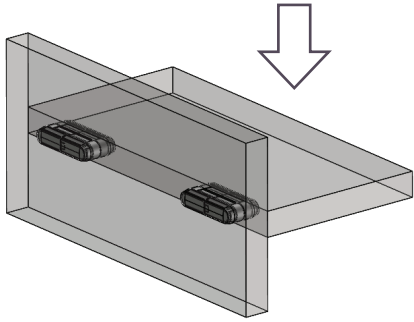

The OVVO® Permanent Connection Set is an ideal solution for connecting materials together permanently.

| Shear   | Tensile   |
|---|---|
|  <p>PH1240 (dual test shear)</p> <p>Chipboard = 600 N</p> <p>MDF = 700 N</p> <p>Beech = 1000 N</p> |  <p>PH1240 (component test tensile)</p> <p>Per Component = 500 N</p> |

# PERMANENT SET FITTING INSTRUCTIONS



2 x PH 1240 = PERMANENT HOUSING  
1 x PC 1240 = PERMANENT CONNECTOR

## Milling

- (i) Plunge Depth: 12.9mm, +/- 0.5mm
- (ii) Travel (Centre to Centre): 39.3mm
- Out to Out: 51.3mm

## CNC Speeds

- Plunge: 2.5 Metres
- Travel: 5 Metres - 7.5 Metres
- Rotation: 18,000 Revolutions

*Speeds vary with different materials.*

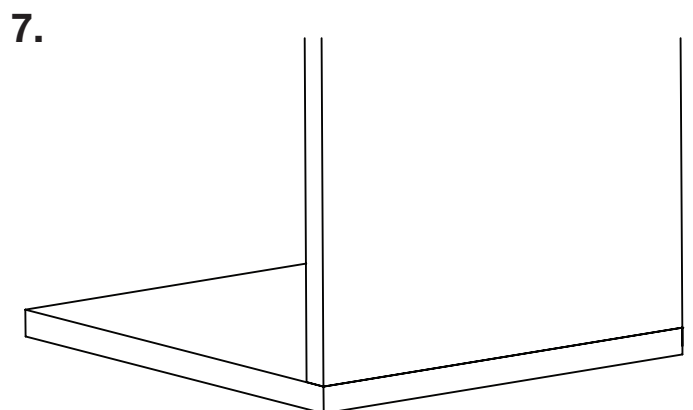
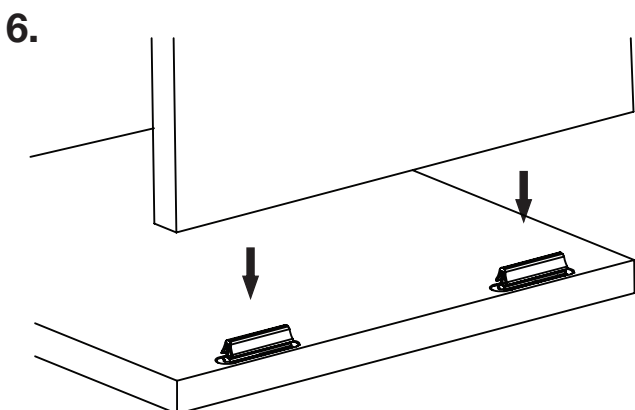
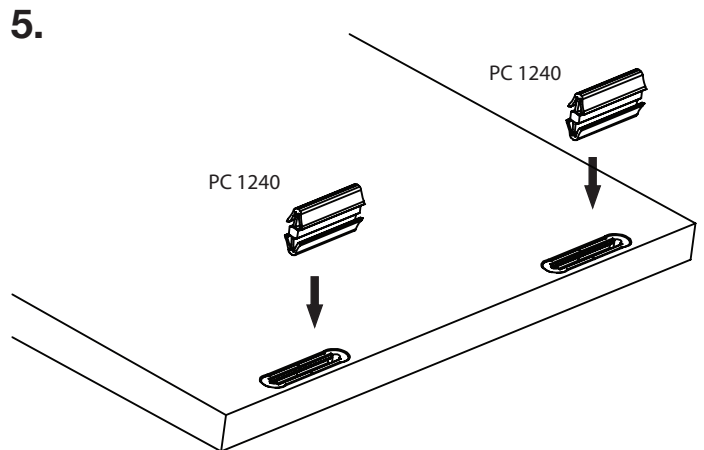
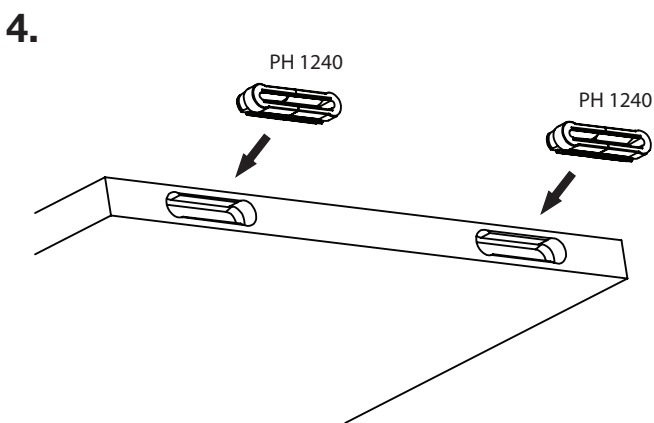
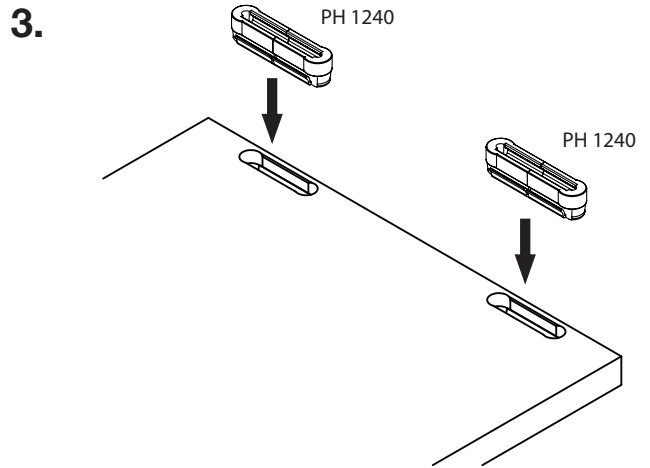
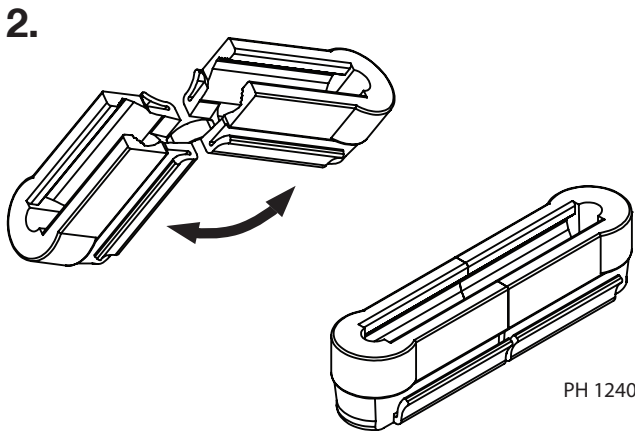
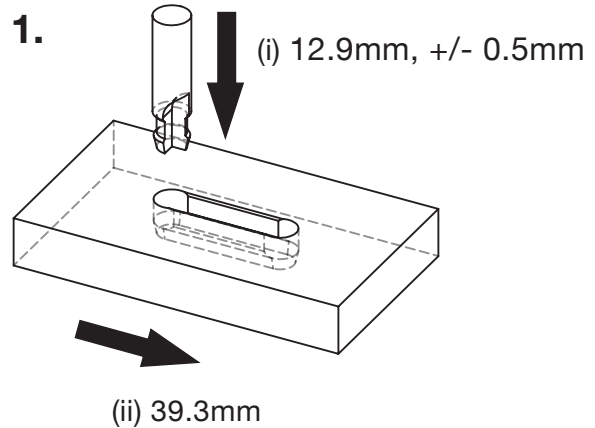

# Important! Set Depth Correctly

## OVVO® 1240 Connection System



IMPORTANT! MAKE A TEST  
WICHTIG! MACHEN SIE EINEN TEST  
IMPORTANT! FAIRE UN TEST  
IMPORTANTE! FARE UN TEST  
IMPORTANTE! HACER UNA PRUEBA

### RECOMMENDED DEPTH TOLERANCES

|      |                   |
|------|-------------------|
| 1240 | 12.9mm, +/- 0.5mm |
|------|-------------------|

Set the depth tolerance to 12.9mm and adjust +/- 0.5mm if required

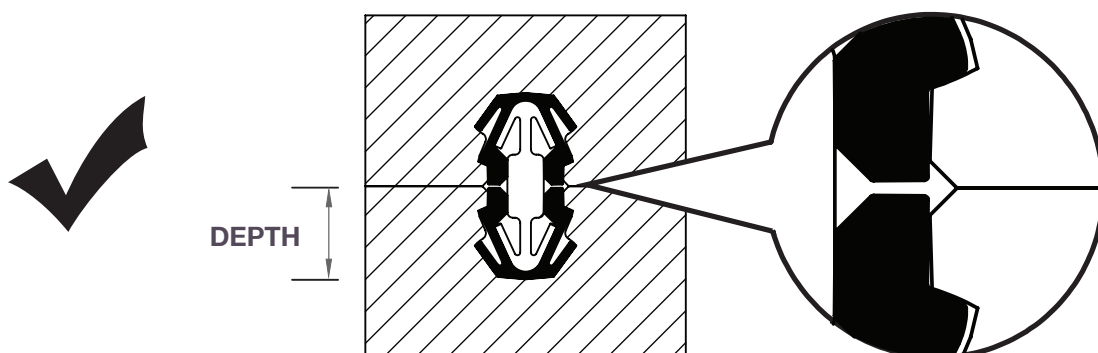

Less than 12.4mm will create an open joint

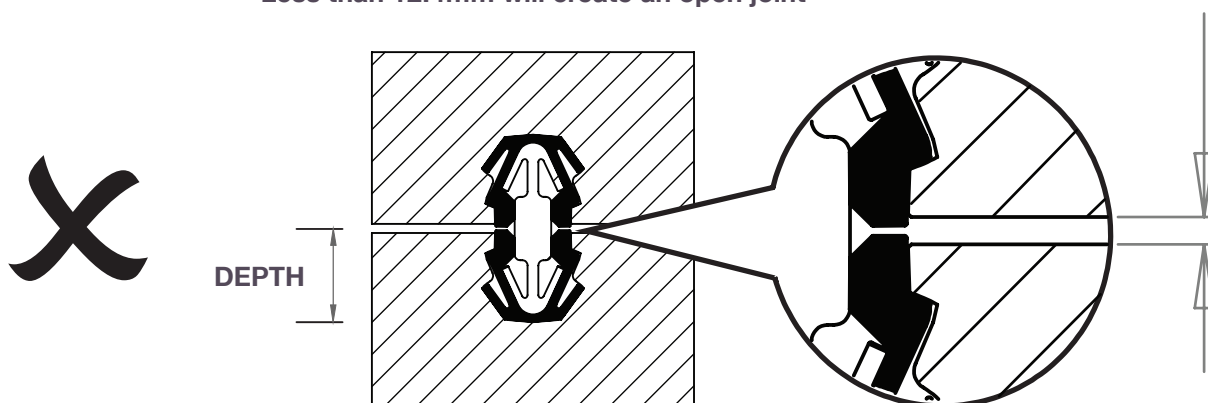

Greater than 13.4mm connector wing can not lock

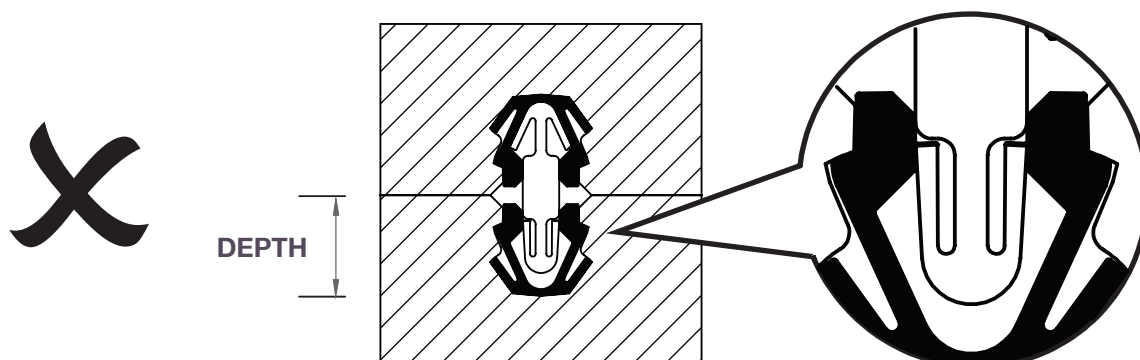

# Depth Setting Guide

## OVVO® 1240 Connection System



- 1.** Make a long cut with your tooling. Approximately 200mm long and 12.9mm depth

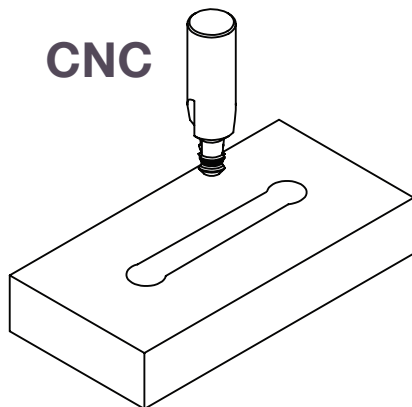

or

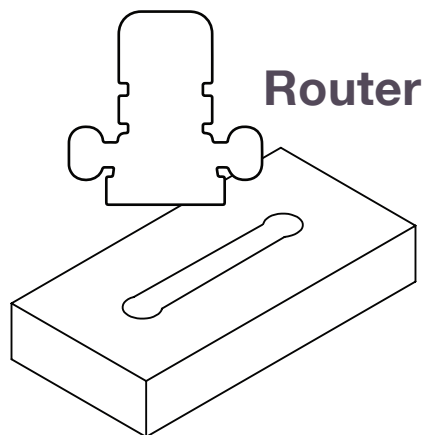

- 2.** Cut in half

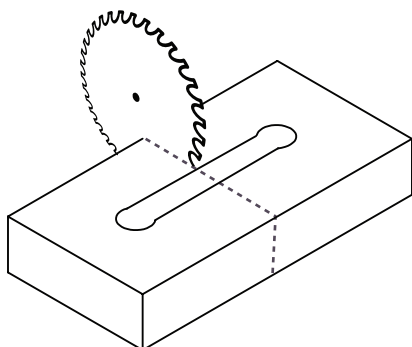

- 3.** Insert Connection Set and check depth.

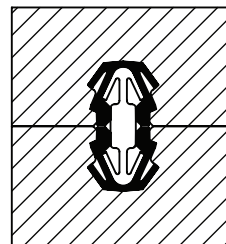

**X** Depth incorrect

Open joint?  
Increase depth.

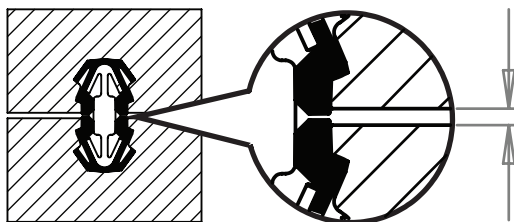

Wings not locking?  
Reduce depth.

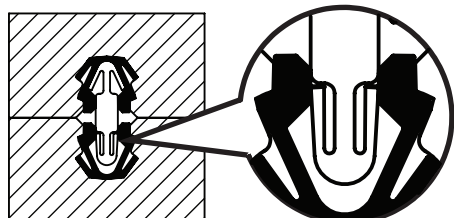

**✓** Depth correct

