

# INSTRUCTIONS

## V-1230PD-10 + V1230PH

### 1. Drilling for V-1230PD-10

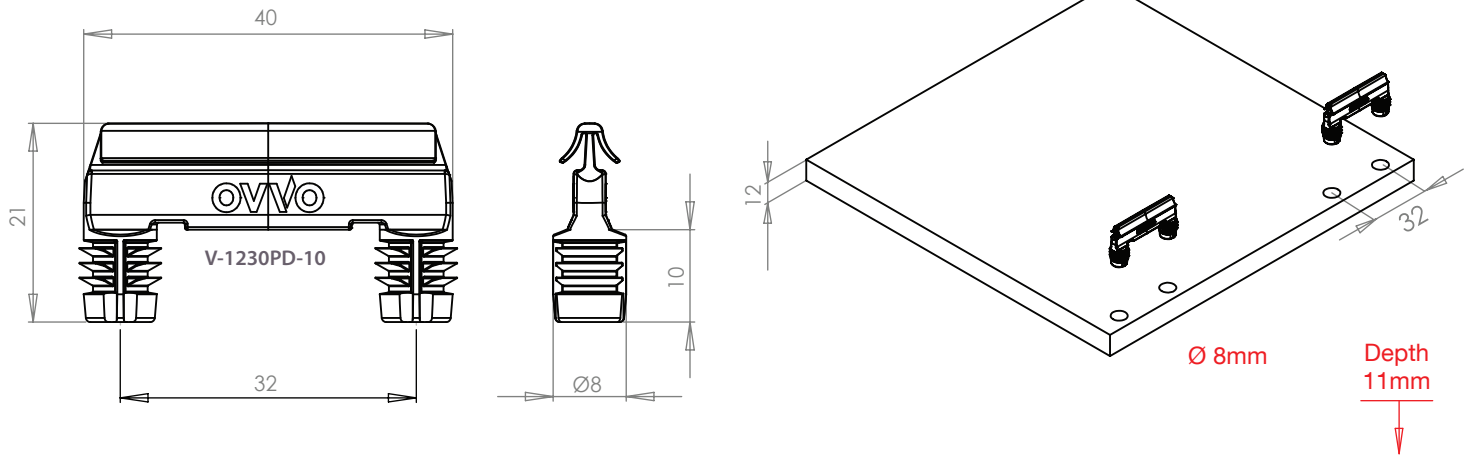

### 2. Milling for V-1230PH

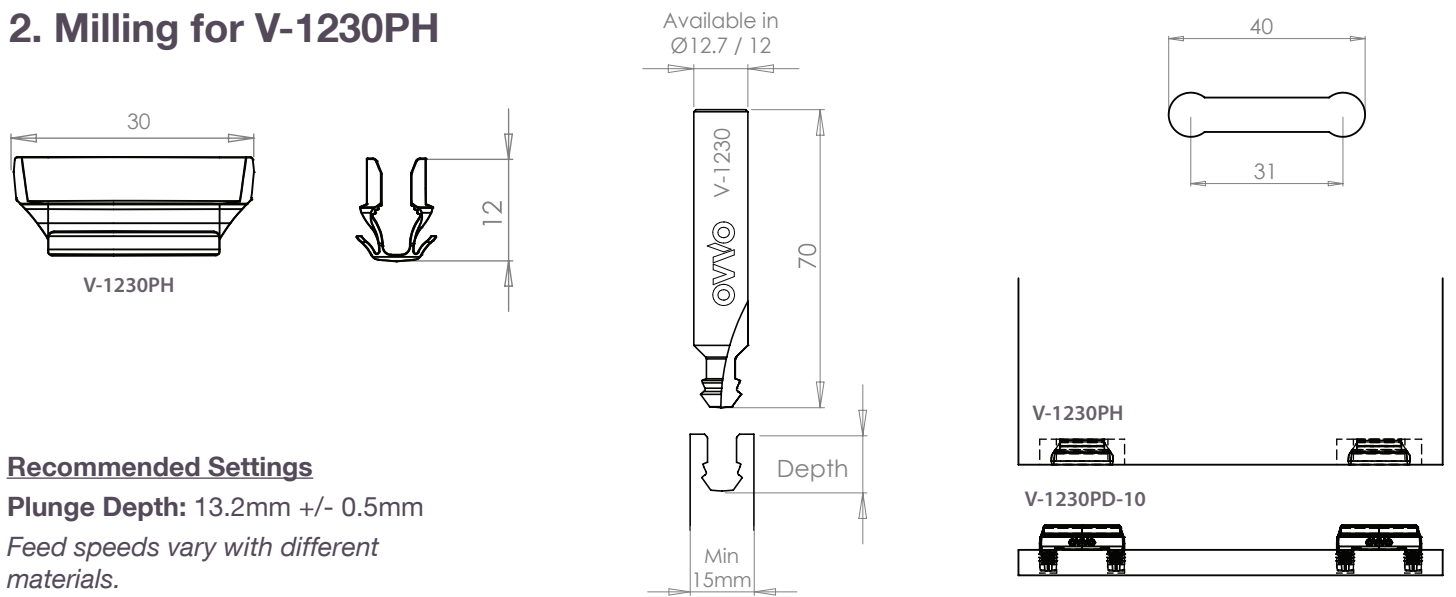

### 3. Assembly

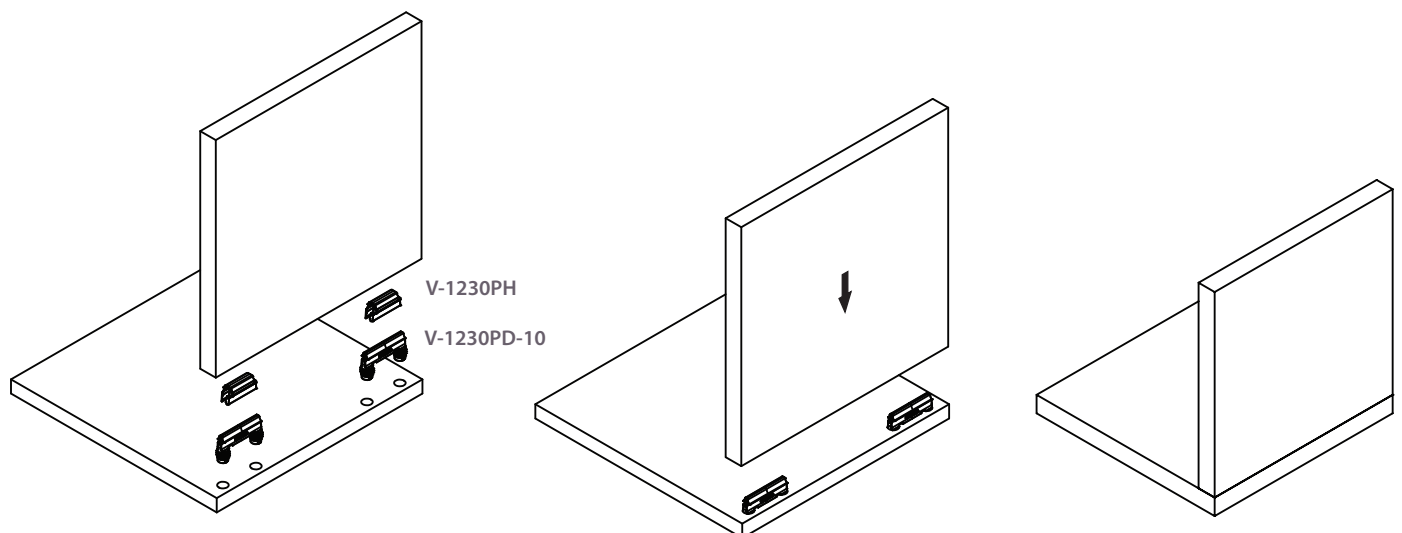

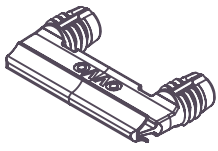

# INSTRUCTIONS

## V-1230PD-10

### 1. Drilling for V-1230PD-10

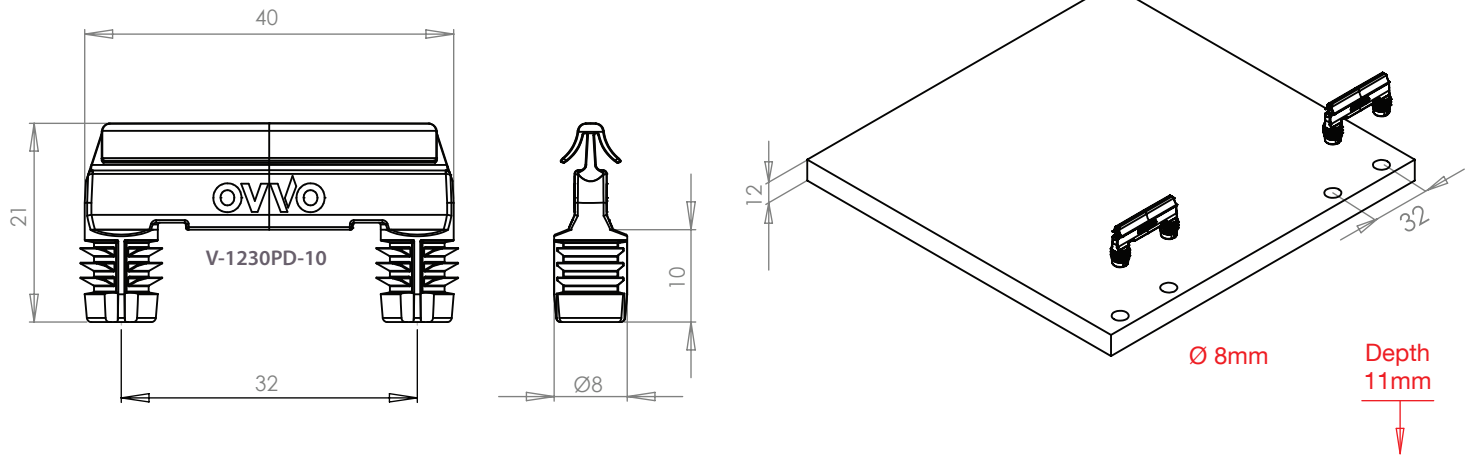

### 2. Milling Examples

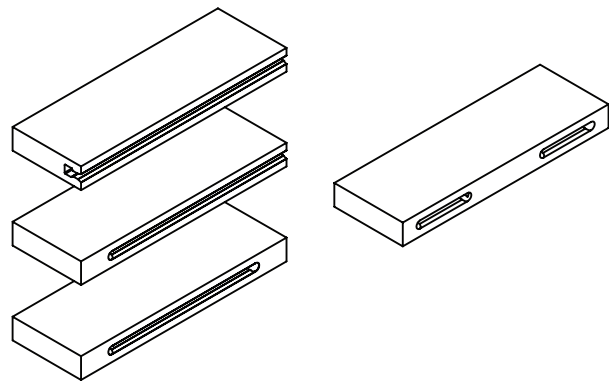
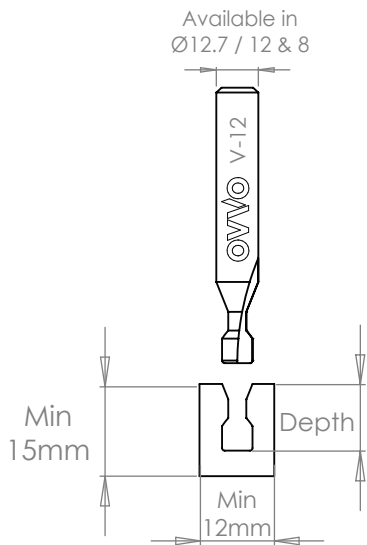

#### Recommended Settings

**Plunge Depth:** 12mm +/- 0.3mm

*Feed speeds vary with different materials*

**Tip:** Plunge, Travel, Back Travel to clear excess milling dust

### 3. Assembly

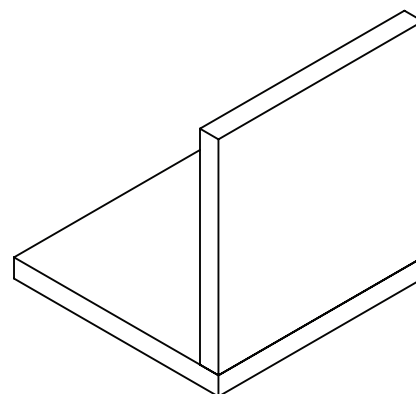
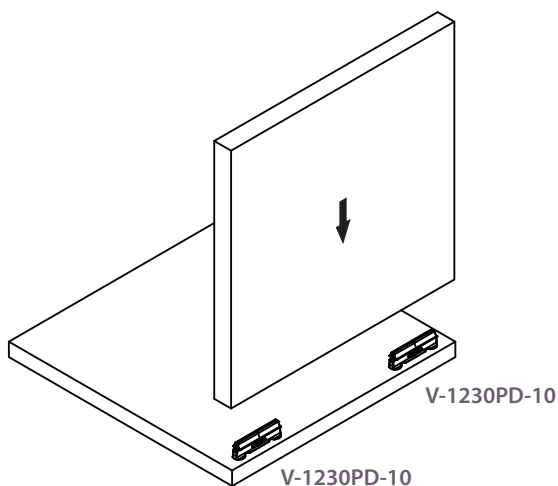

Can be used with glue

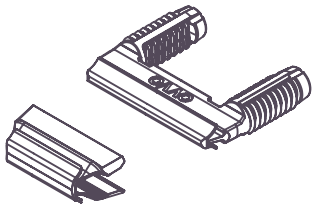

# INSTRUCTIONS

## V-1230PD-20 + V1230PH

### 1. Drilling for V-1230PD-20

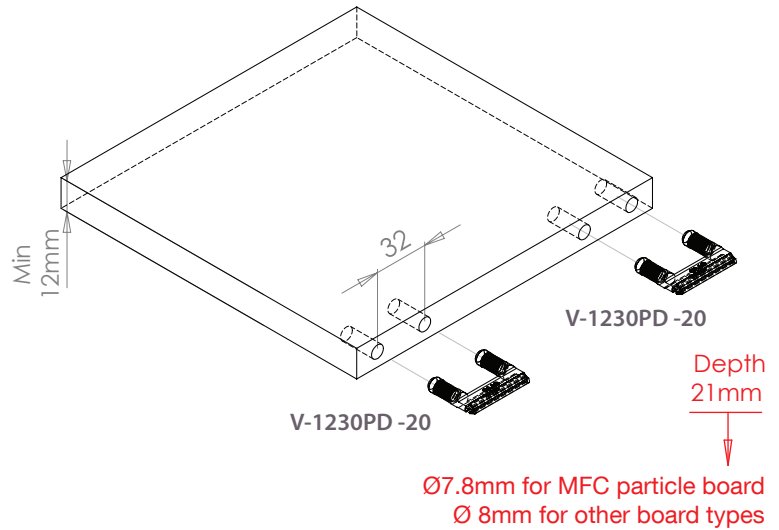
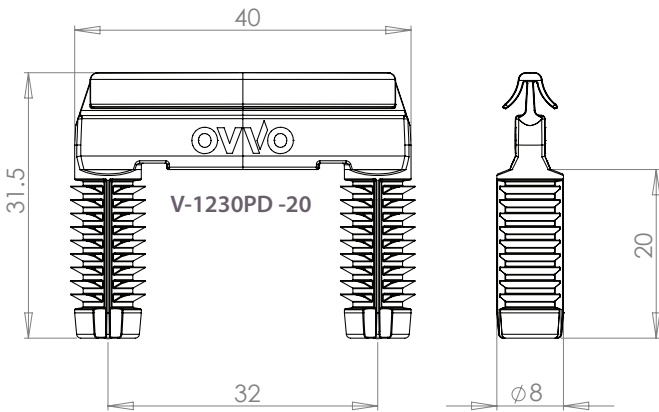

### 2. Milling for V-1230PH

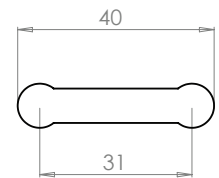
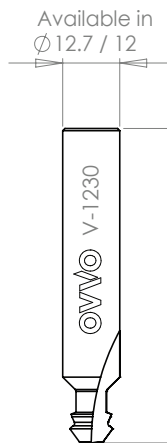
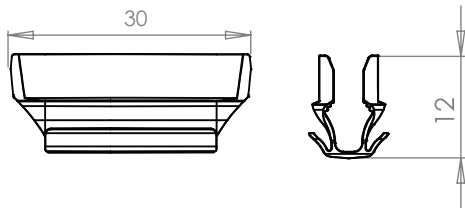

#### Recommended Settings

**Plunge Depth:** 13.2mm +/- 0.5mm

Feed speeds vary with different materials.

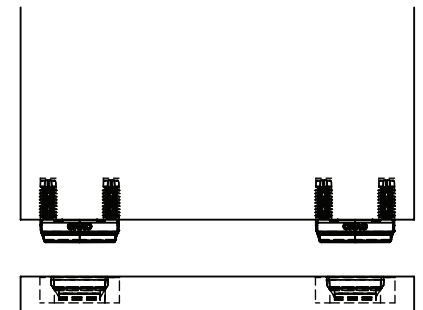
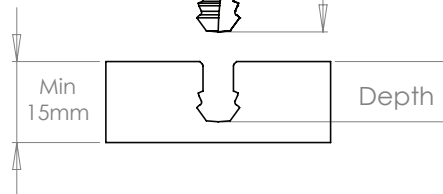

### 3. Assembly

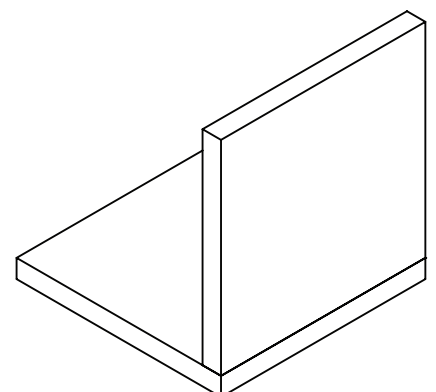
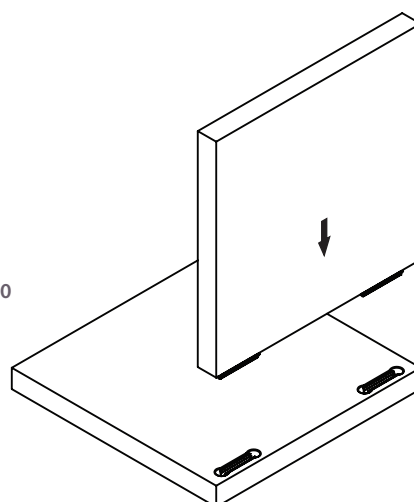
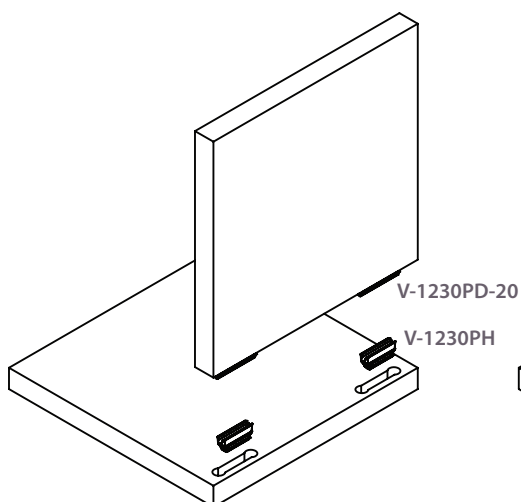

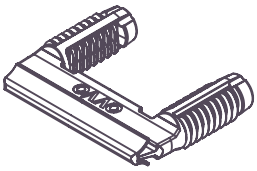

# INSTRUCTIONS

## V-1230PD-20

### 1. Drilling for V-1230PD-20

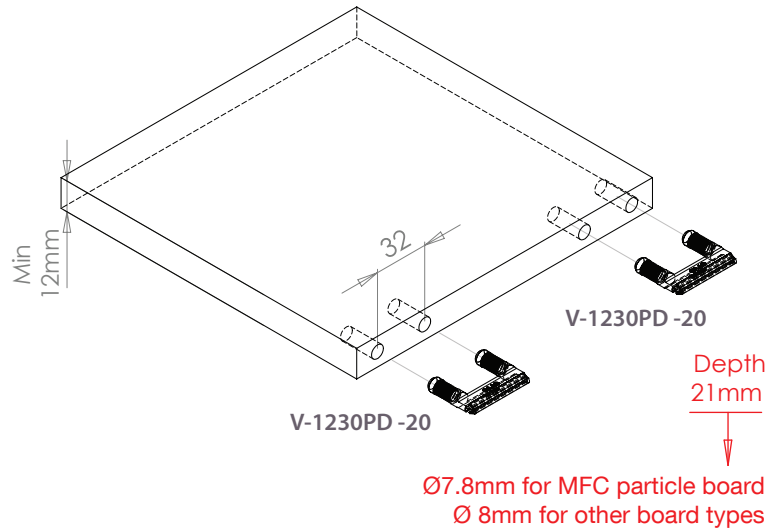
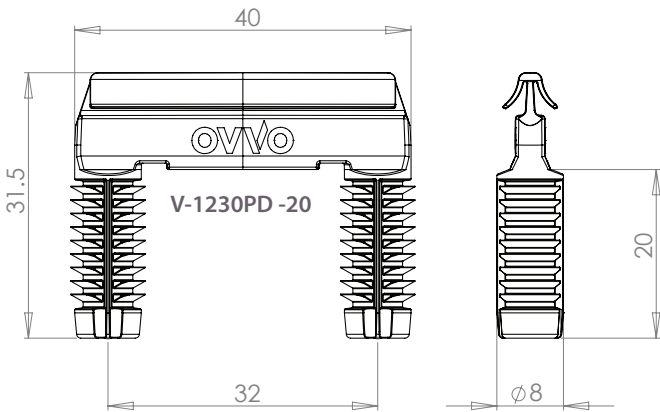

### 2. Milling Examples

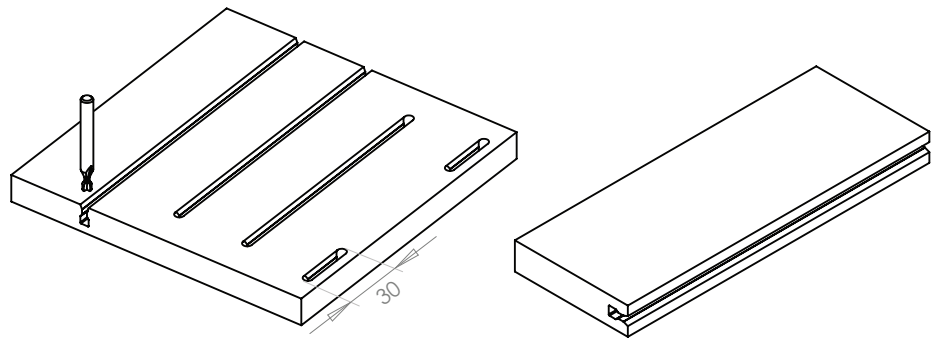
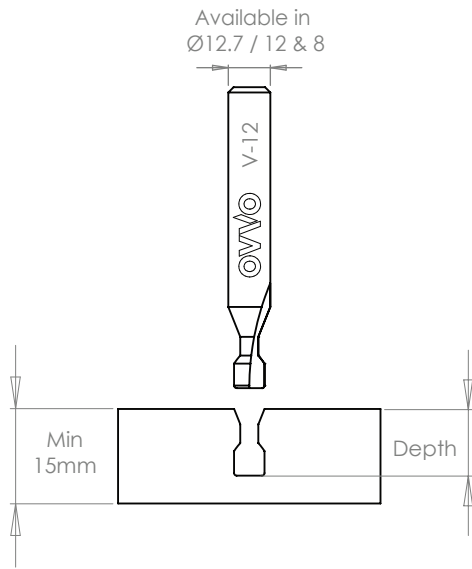

#### Recommended Settings

**Plunge Depth:** 12mm +/- 0.3mm

*Feed speeds vary with different materials*

**Tip:** Plunge, Travel, Back Travel to clear excess milling dust

### 3. Assembly

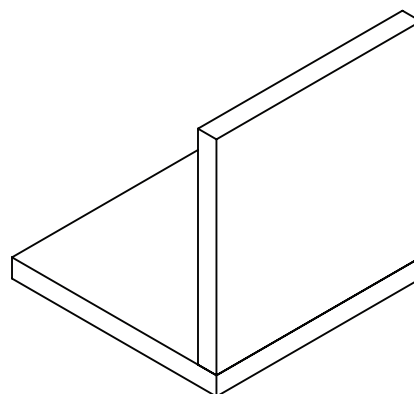
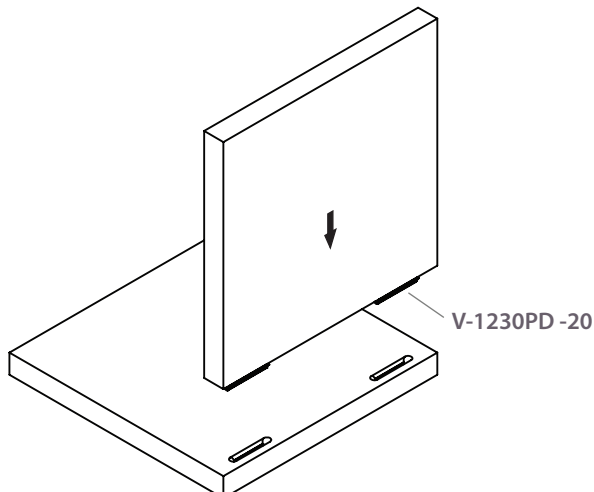

Can be used with glue

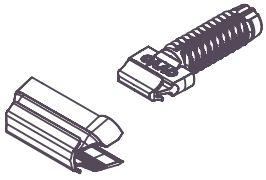

# INSTRUCTIONS

## V-1230RD-25 + V1230RH

### 1. Drilling for V-1230RD-25

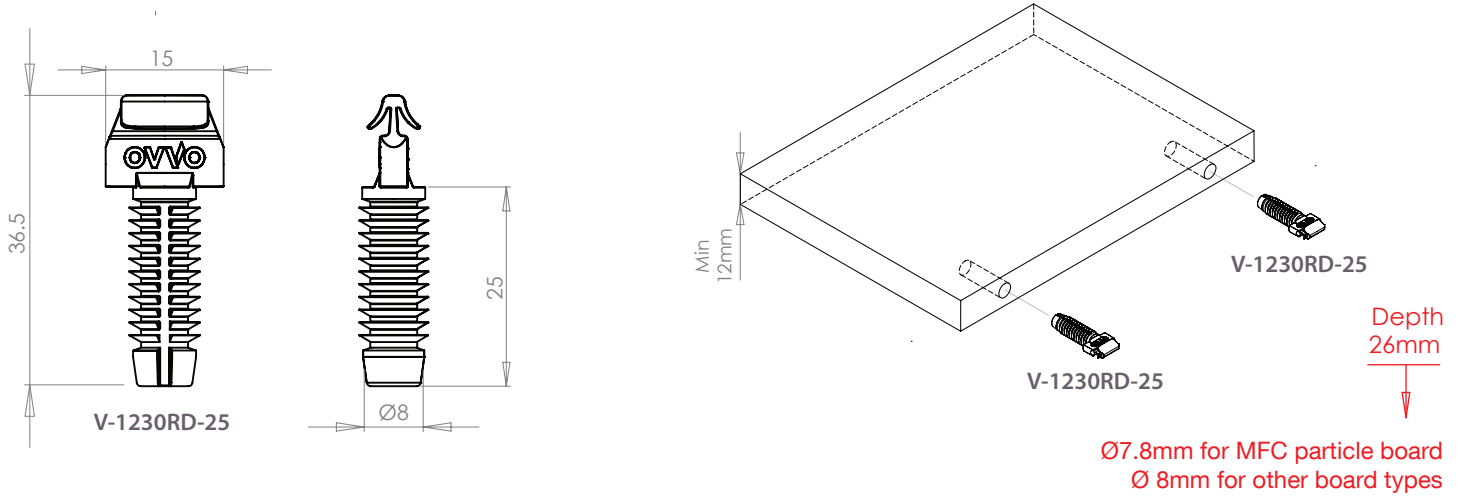

### 2. Milling for V-1230RH

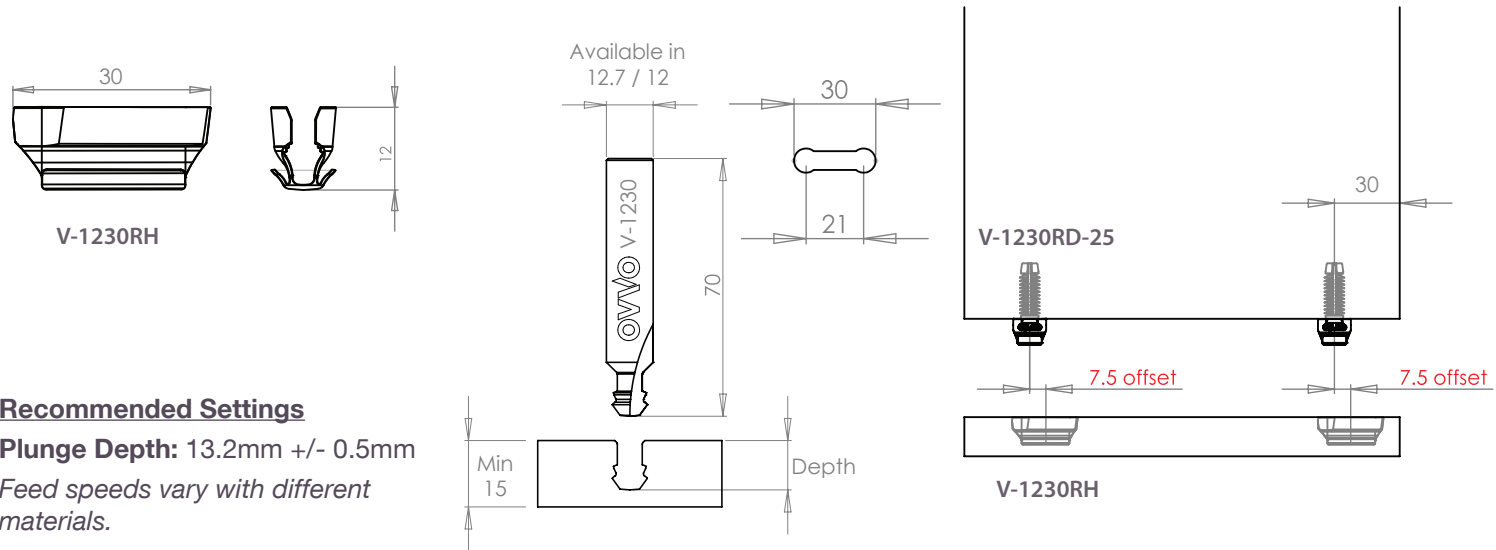

#### Recommended Settings

**Plunge Depth:** 13.2mm +/- 0.5mm

*Feed speeds vary with different materials.*

### 3. Assembly

