

V-0930PC

Instructions

1. Connector V-0930

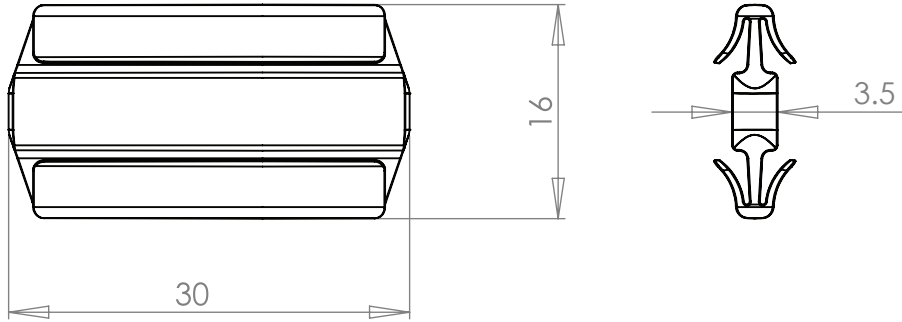

2. Milling Examples

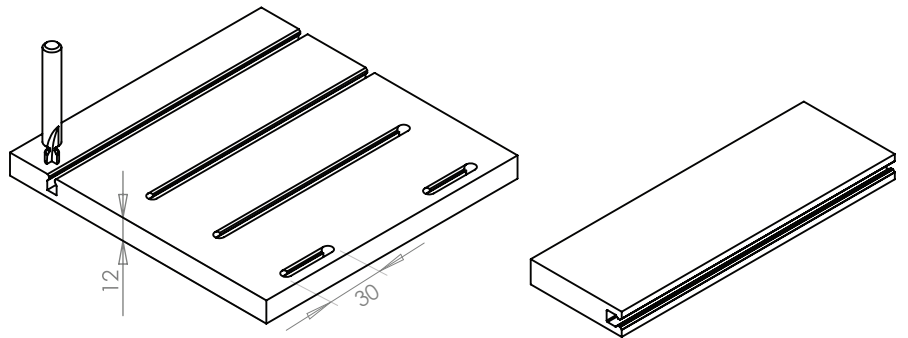
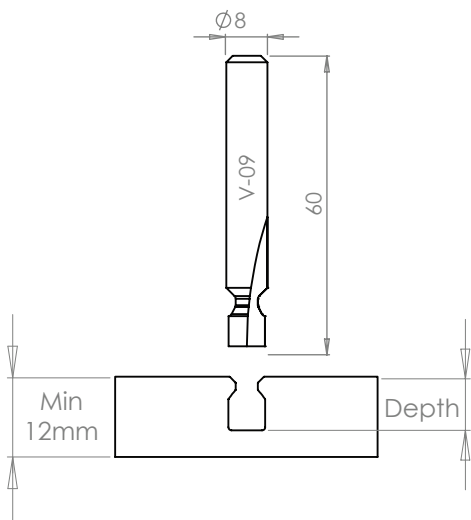

Recommended Settings

Depth: 8.5mm +/- 0.3mm

Rotation: Speeds vary with different materials.

Recommended Spacing: 100mm / 300 mm

3. Assembly

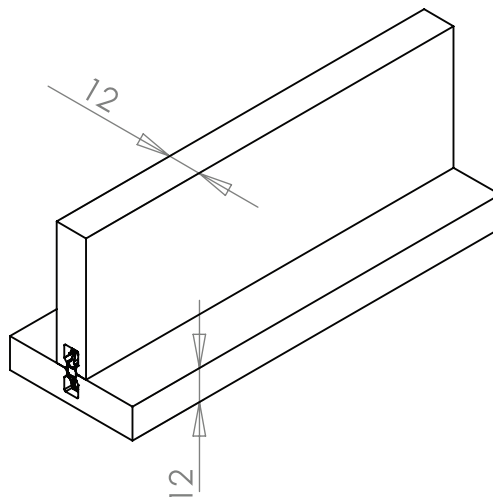
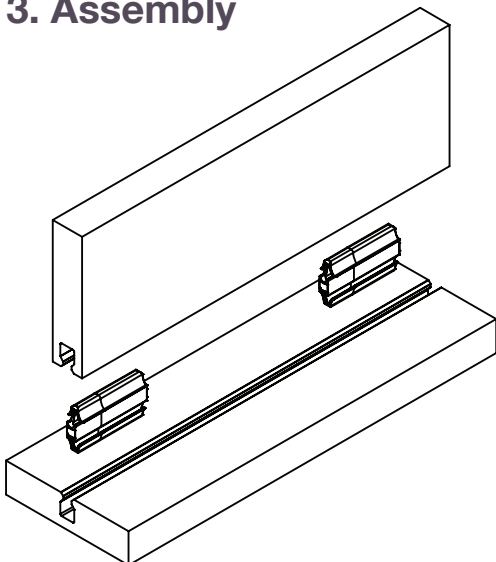

Can be used
with glue

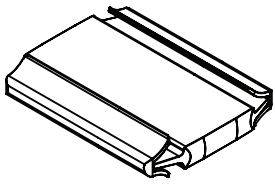

INSTRUCTIONS

V-1230PC

1. Connector V-1230PC

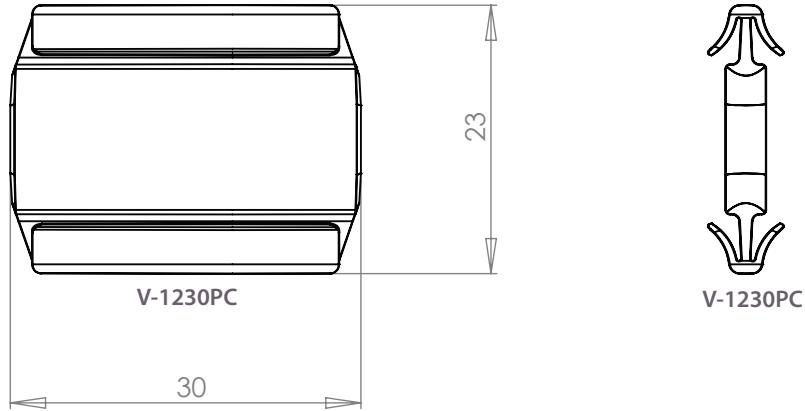

2. Milling Examples

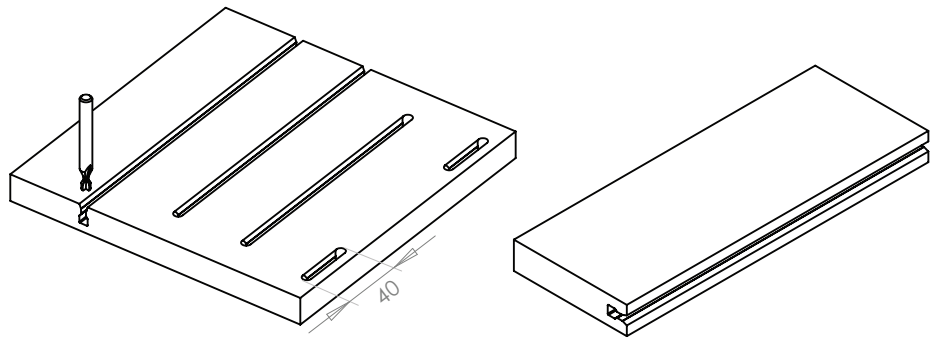
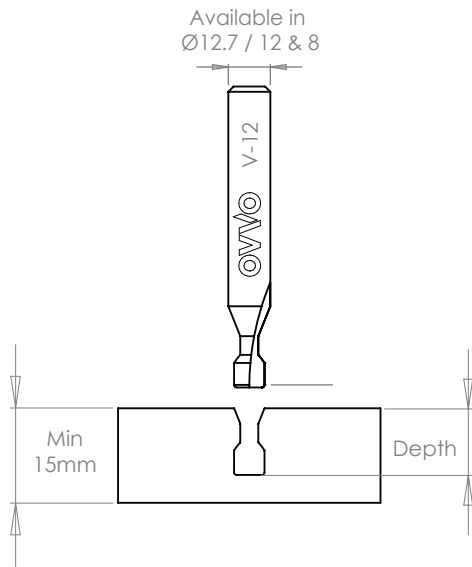

Recommended Settings

Plunge Depth: 12mm +/- 0.3mm

Feed speeds vary with different materials.

Tip: *Plunge, Travel, Back Travel to clear excess milling dust*

3. Assembly

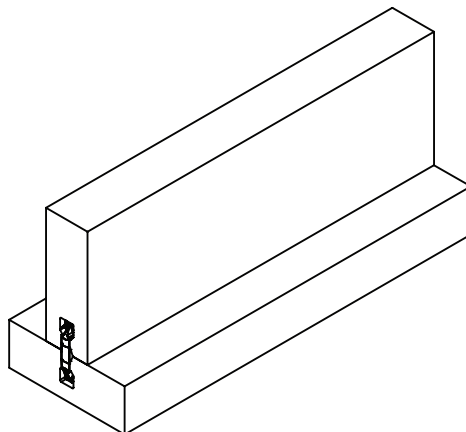
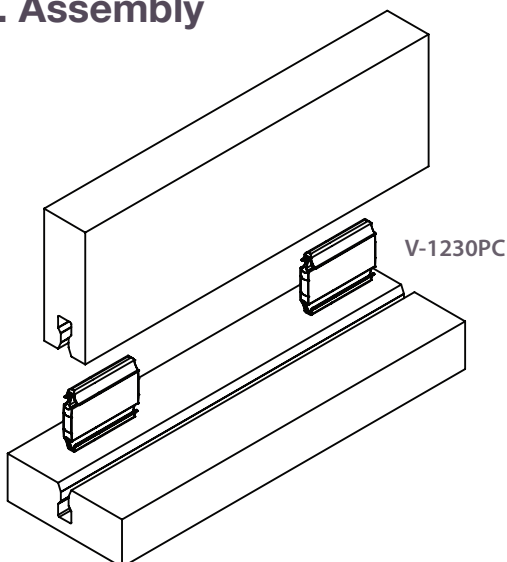

Can be used
with glue