

# OVVO® V Connection System

## V-1230 Permanent Specifications

THE FUTURE OF CONNECTION



### V-1230 Permanent

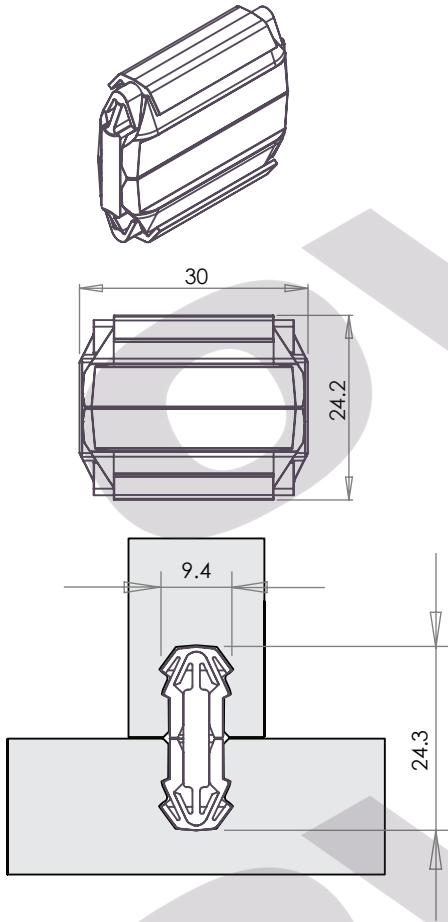

### V-1230PH

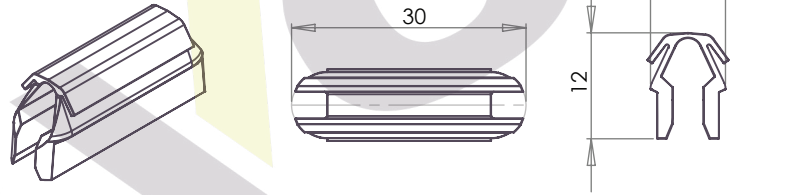

### V-1230PC

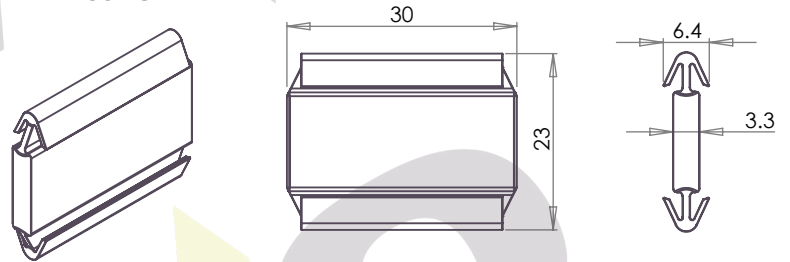

### V-1230PH

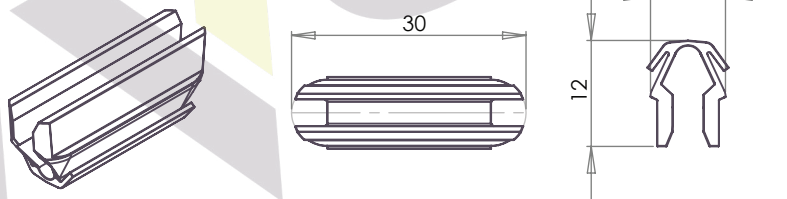

- (i) Plunge
- (ii) Travel
- (iii) Out

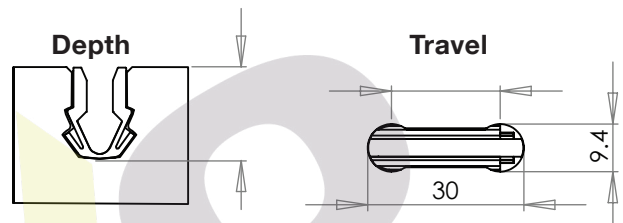
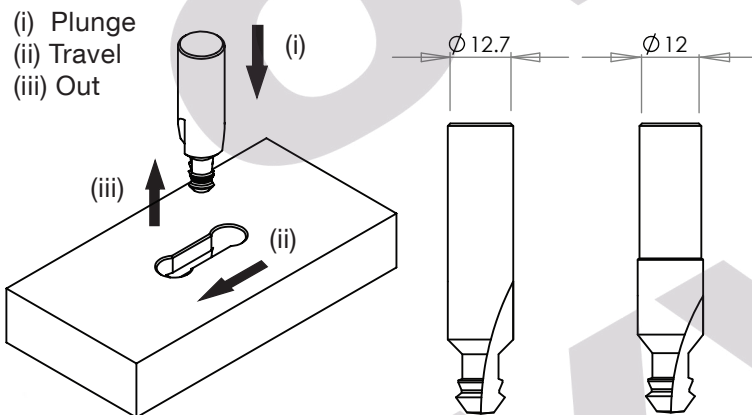

#### Recommended Settings

**Depth:** 12.5mm, +/- 0.5mm

**Travel Centre to Centre:** 20.5mm (min) - 20.7mm

**Rotation Speed:** CNC speeds vary with different materials. Maximum cutter rotation: 18,000

### How it works

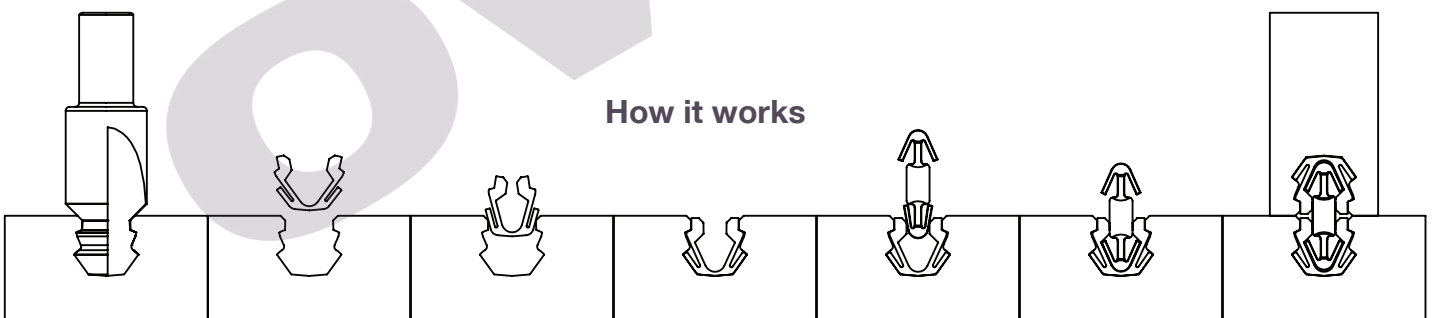

# OVVO® V Connection System

## V-1230 Releasable Specifications

THE FUTURE OF CONNECTION



### V-1230 Releasable

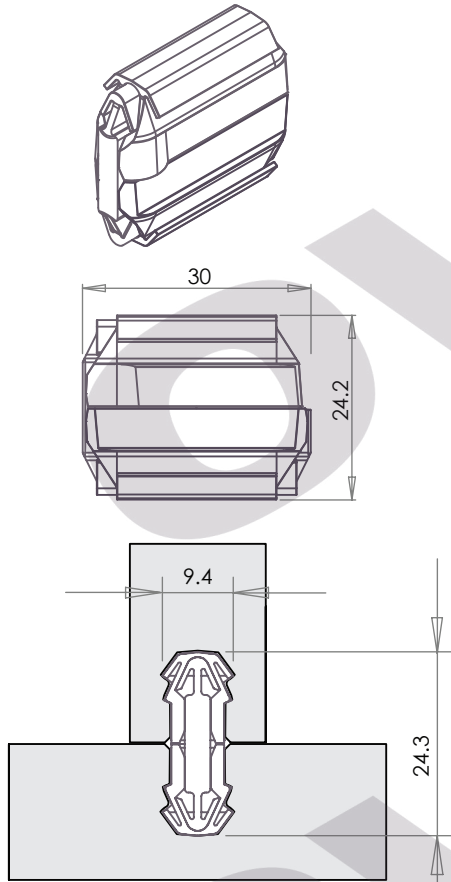

### V-1230RH

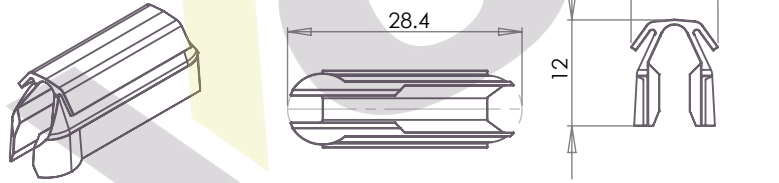

### V-1230RC

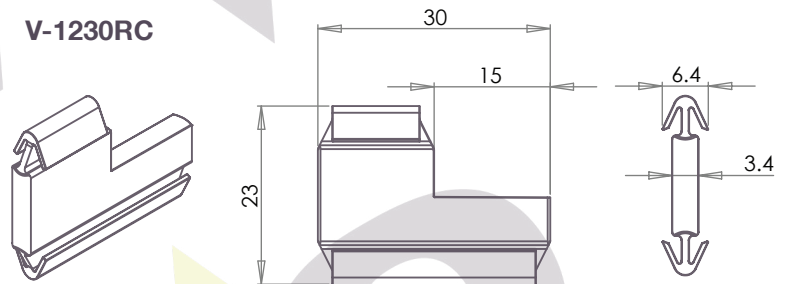

### V-1230PH

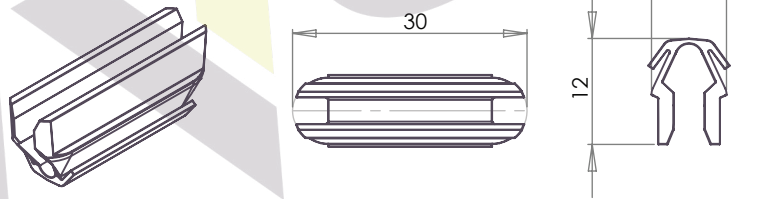

- (i) Plunge
- (ii) Travel
- (iii) Out

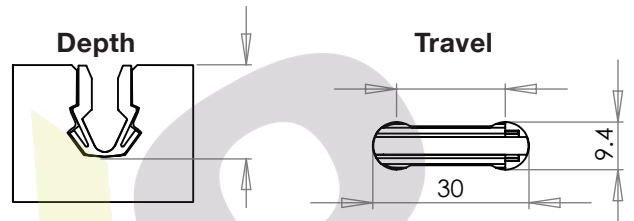
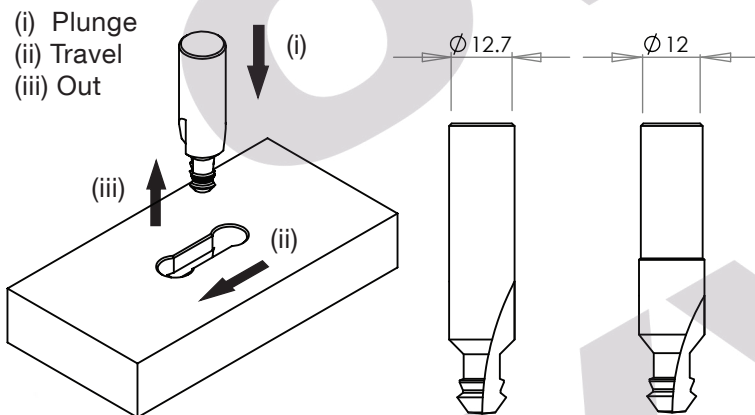

#### Recommended Settings

**Depth:** 12.5mm, +/- 0.5mm

**Travel Centre to Centre:** 20.5mm (min) - 20.7mm

**Rotation Speed:** CNC speeds vary with different materials. Maximum cutter rotation: 18,000

### How it works

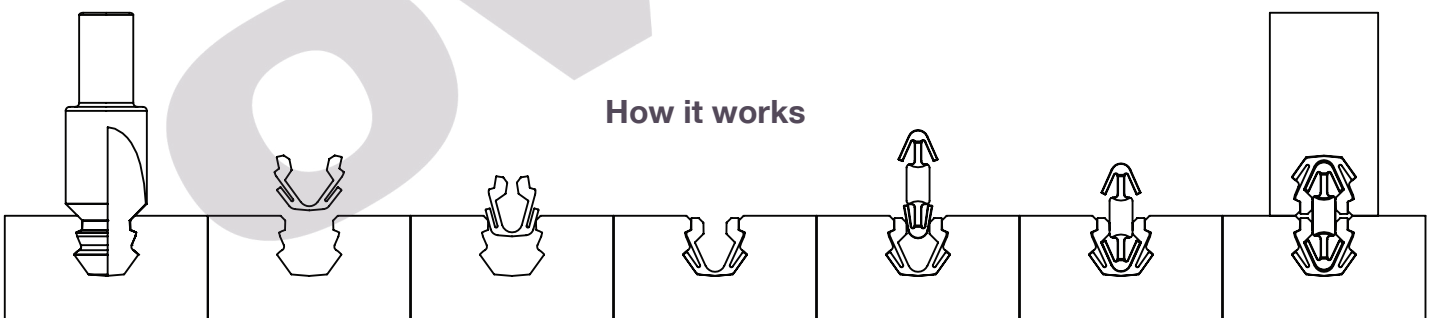

# V-1230 Recommended Minimum Board Depth

Recommended minimum board depth or thickness values for the V-1230 will change depending on both the substrate material used as well as the joint angle.

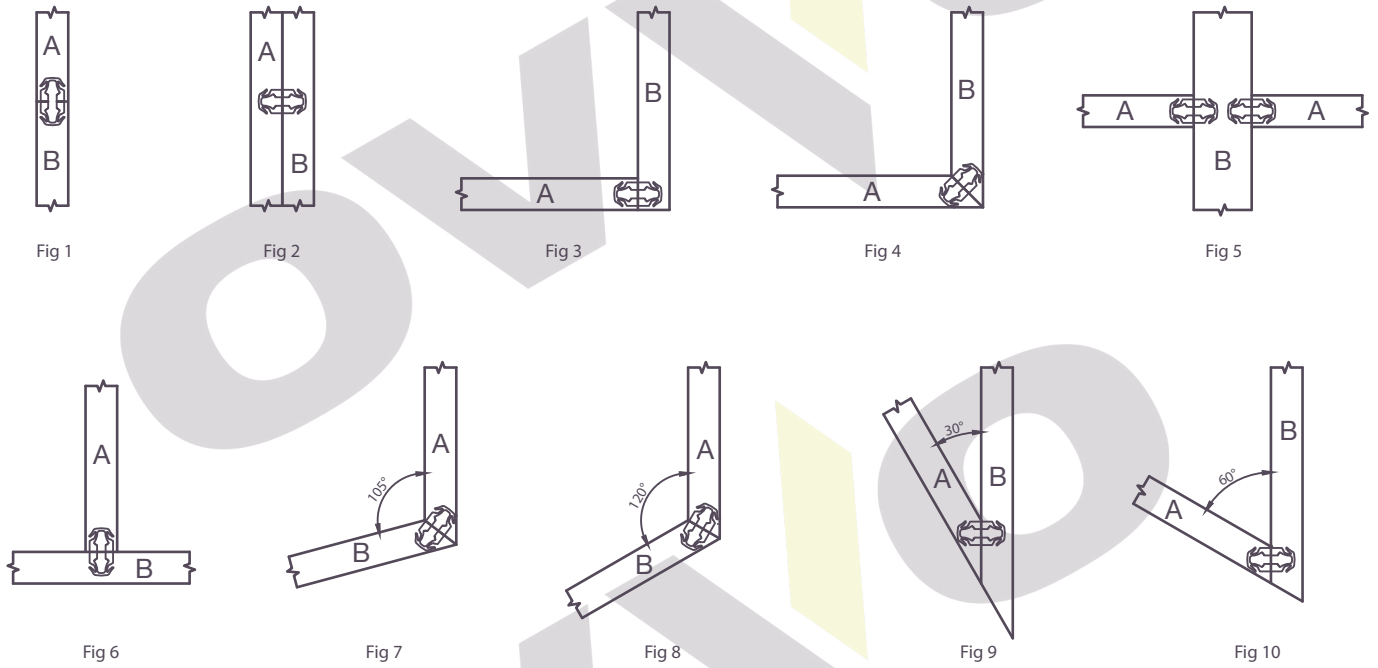

Minimum recommended measurements shown below are categorized according to two distinct groups of board material which share broadly similar connector retention properties.

|        | HPL, Composite, Solid Surface, Hardwoods, Birch Plywood |      |
|--------|---|------|
|        | A   | B    |
| Fig 1  | 12mm  | 12mm |
| Fig 2  | 15mm  | 15mm |
| Fig 3  | 12mm  | 15mm |
| Fig 4  | 15mm  | 15mm |
| Fig 5  | 12mm  | 30mm |
| Fig 6  | 12mm  | 15mm |
| Fig 7  | 16mm  | 16mm |
| Fig 8  | 16mm  | 16mm |
| Fig 9  | 16mm  | 16mm |
| Fig 10 | 16mm  | 16mm |

|        | Particle/Chipboard, Softwoods, MDF |      |
|--------|------------------------------------|------|
|        | A                                  | B    |
| Fig 1  | 15mm                               | 15mm |
| Fig 2  | 15mm                               | 15mm |
| Fig 3  | 15mm                               | 15mm |
| Fig 4  | 15mm                               | 15mm |
| Fig 5  | 15mm                               | 30mm |
| Fig 6  | 15mm                               | 15mm |
| Fig 7  | 16mm                               | 16mm |
| Fig 8  | 18mm                               | 18mm |
| Fig 9  | 16mm                               | 16mm |
| Fig 10 | 18mm                               | 18mm |

These are guidelines only and OVVO® recommends trial connections be made before going into full production.

# OVVO® V Connection System

## V-1230 Shear & Tensile

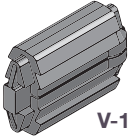
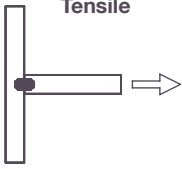
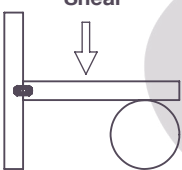
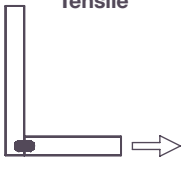
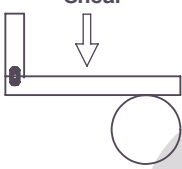
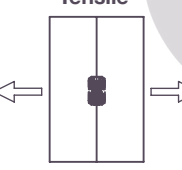
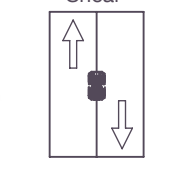
| <br>V-1230                                  | 18mm Chipboard |            | 18mm MDF  |            | 18mm Plywood |            | 12mm Plywood |            | 12mm HPL  |            |
|--|----------------|------------|-----------|------------|--------------|------------|--------------|------------|-----------|------------|
|  | Permanent      | Releasable | Permanent | Releasable | Permanent    | Releasable | Permanent    | Releasable | Permanent | Releasable |
| <b>Tensile</b><br><br>2 x V-1230 per test   | 75kg           | 62.5kg     | 80kg      | 50kg       | 165kg        | 100kg      | 90kg         | 69kg       | -         | -          |
| <b>Shear</b><br><br>2 x V-1230 per test     | 180kg          | 155kg      | 210kg     | 155kg      | 570kg        | 390kg      | 200kg        | 130kg      | -         | -          |
| <b>Tensile</b><br><br>2 x V-1230 per test  | 47.5kg         | 47.5kg     | -         | -          | -            | -          | -            | -          | -         | -          |
| <b>Shear</b><br><br>2 x V-1230 per test   | 100kg          | 100kg      | -         | -          | -            | -          | -            | -          | -         | -          |
| <b>Tensile</b><br><br>1 x V-1230 per test | 60kg           | 35kg       | 60kg      | 40kg       | -            | -          | 100kg        | 50kg       | 120kg     | 60kg       |
| <b>Shear</b><br><br>1 x V-1230 per test   | 125kg          | 84kg       | 165kg     | 105kg      | -            | -          | 200kg        | 125kg      | 275kg     | 165kg      |

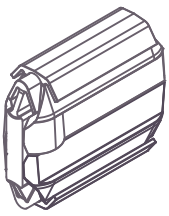

# V-1230

## Releasable Instructions

### 1. Milling

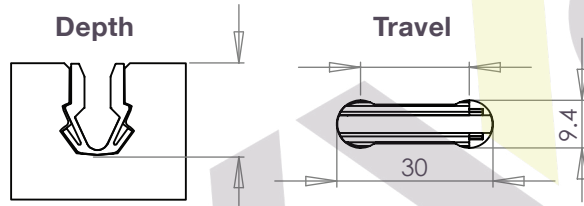
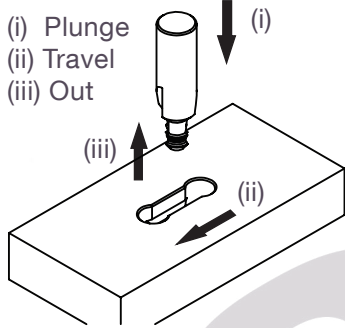

#### Recommended Spacing

- (a): 35mm to 80mm
- (b): 100mm to 250mm

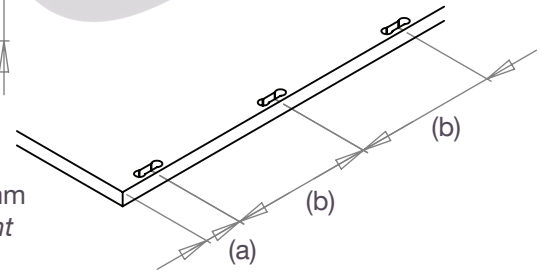

#### Recommended Settings

**Depth:** 12.5mm, +/- 0.5mm  
**Travel Centre to Centre:** 20.5mm (min) - 20.7mm  
**Rotation Speed:** CNC speeds vary with different materials. Maximum cutter rotation: 18,000

### 2. Housing

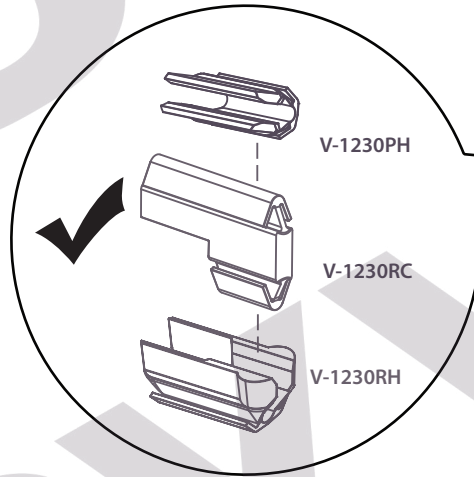
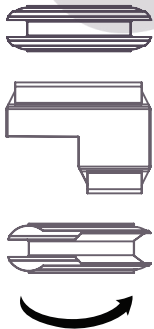

#### Push into place

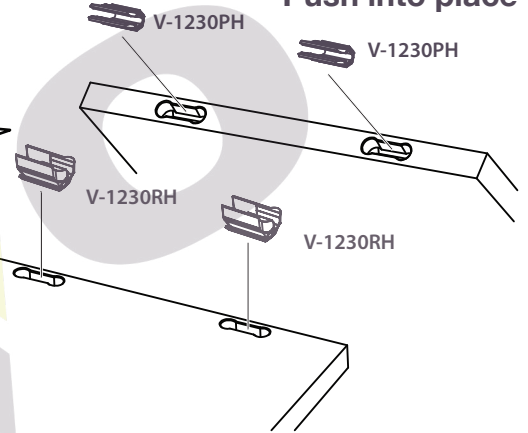

### 3. Assembly - Simply slide to connect

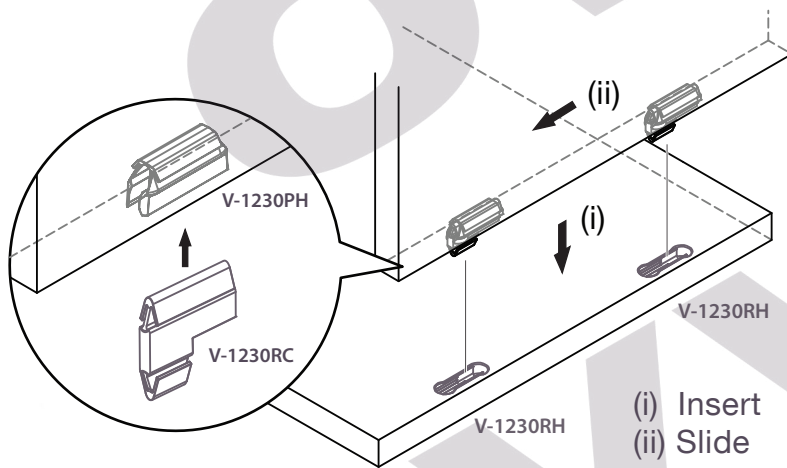

### 4. Release

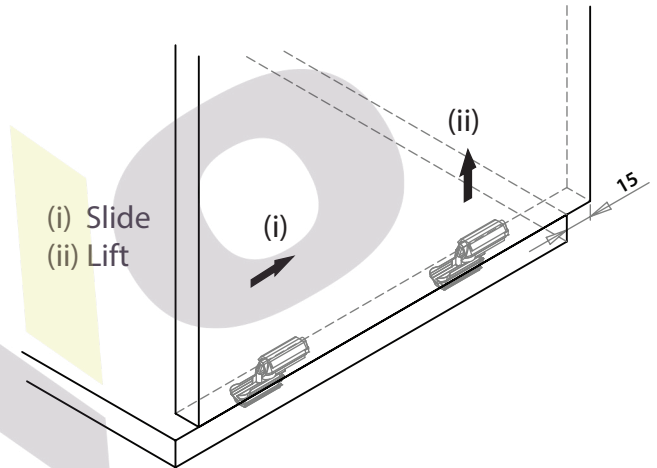

### How it works

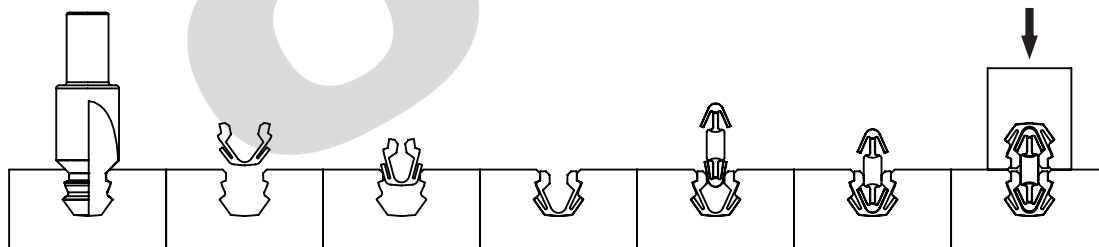

### Simply slide to connect

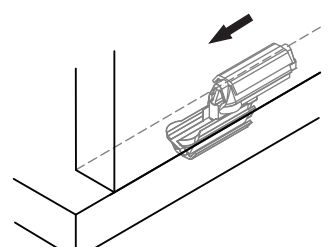

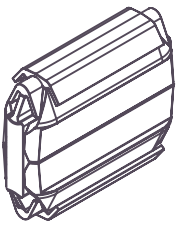

# V-1230

## Permanent Instructions

### 1. Milling

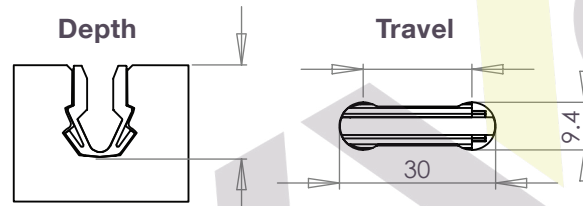
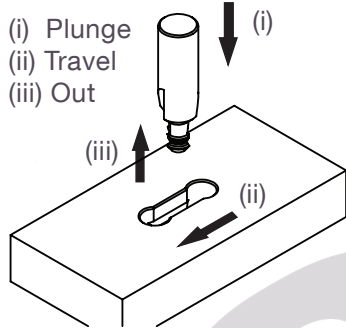

#### Recommended Spacing

- (a): 35mm to 80mm
- (b): 150mm to 350mm

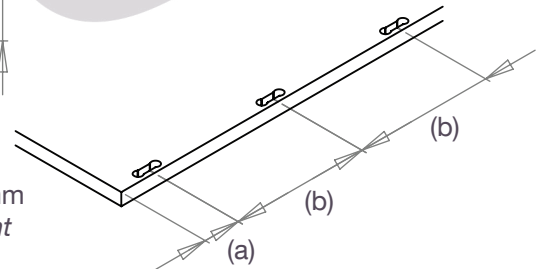

#### Recommended Settings

**Depth:** 12.5mm, +/- 0.5mm  
**Travel Centre to Centre:** 20.5mm (min) - 20.7mm  
**Rotation Speed:** CNC speeds vary with different materials. Maximum cutter rotation: 18,000

### 2. Housing

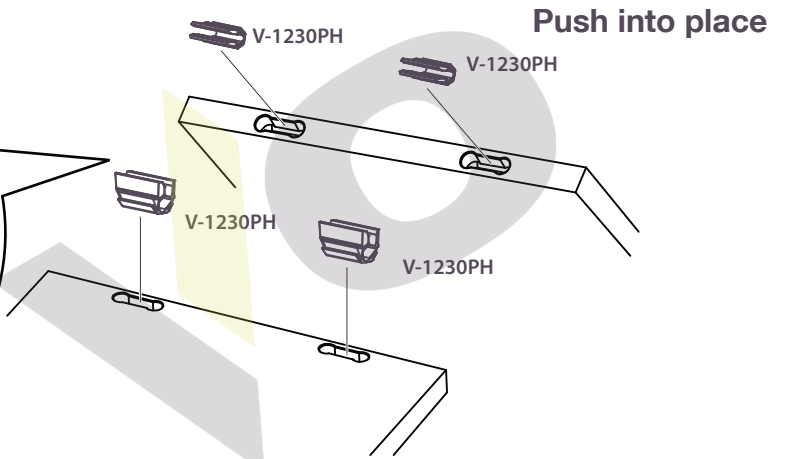
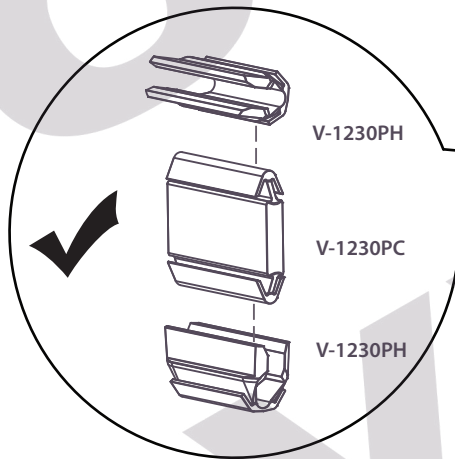

### 3. Assembly - Simply push into place to connect

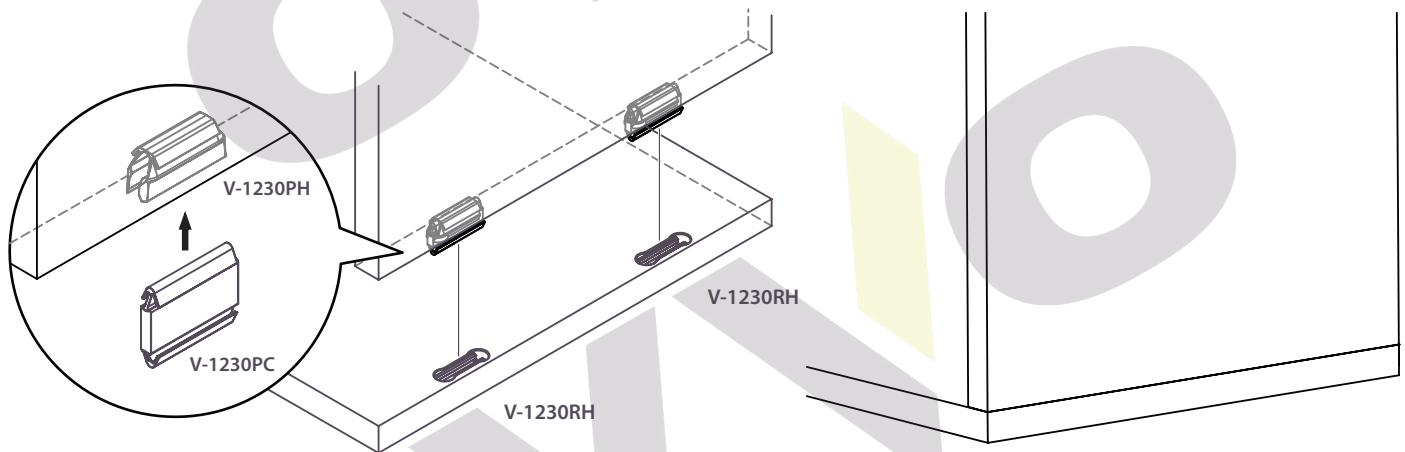

### How it works

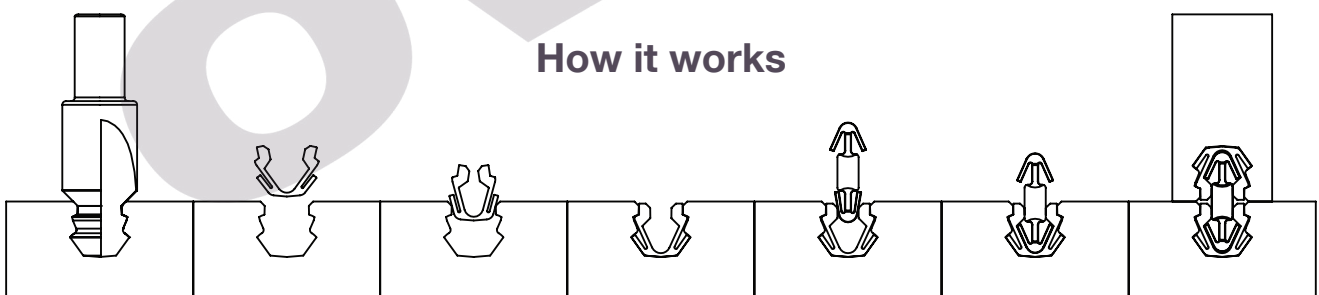

# Important! Set Depth Correctly

## OVVO® V-1230 Connection System



**IMPORTANT! MAKE A TEST**  
**WICHTIG! MACHEN SIE EINEN TEST**  
**IMPORTANT! FAIRE UN TEST**  
**IMPORTANTE! FARE UN TEST**  
**IMPORTANTE! HACER UNA PRUEBA**

### RECOMMENDED DEPTH TOLERANCES

|        |                   |
|--------|-------------------|
| V-1230 | 12.5mm, +/- 0.5mm |
|--------|-------------------|

Set the depth tolerance to 12.5mm and adjust +/- 0.5mm if required

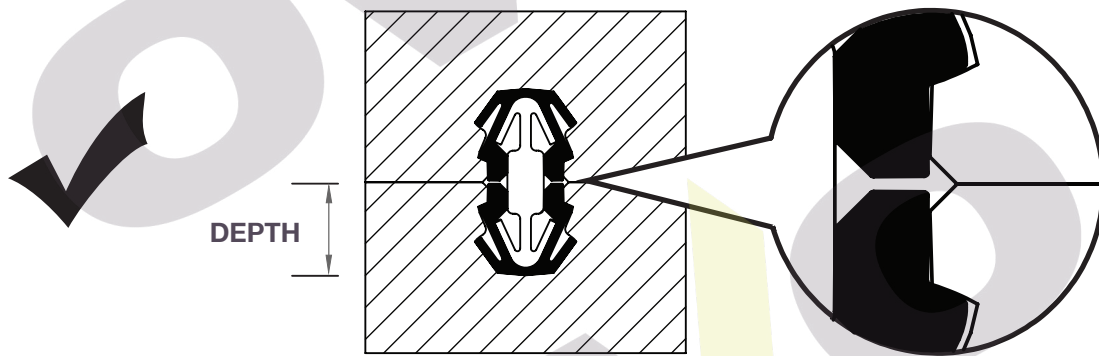

Less than 12mm will create an open joint

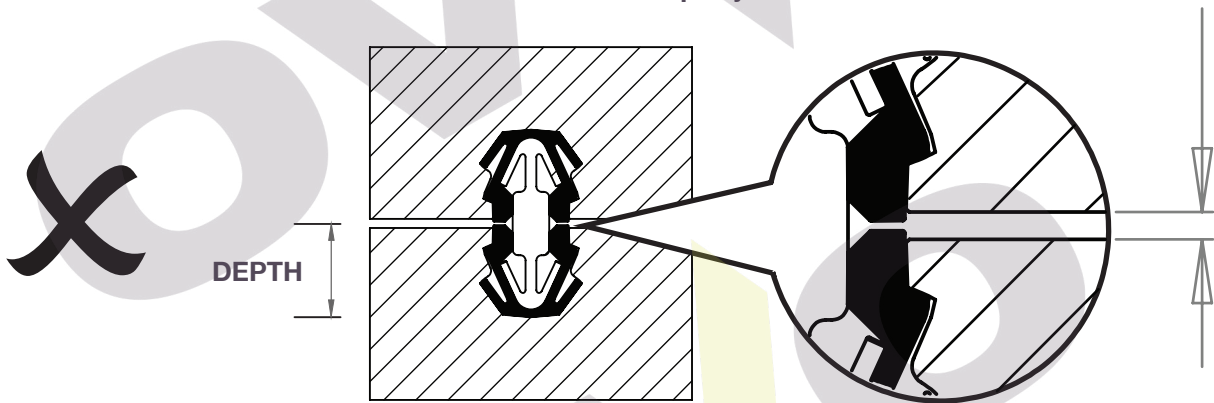

Greater than 13mm connector wing can not lock

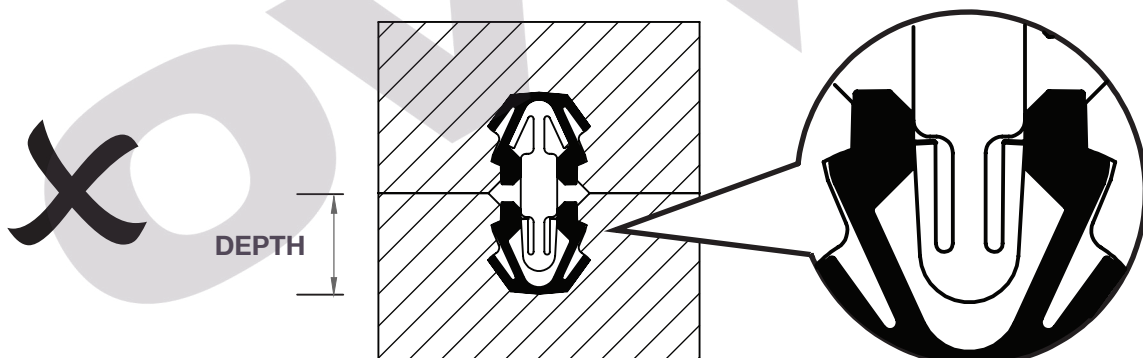



# Depth Setting Guide

## OVVO® V-1230 Connection System

THE FUTURE OF CONNECTION



**1.** Make a long cut with your tooling. Approximately 200mm long and 12.5mm depth

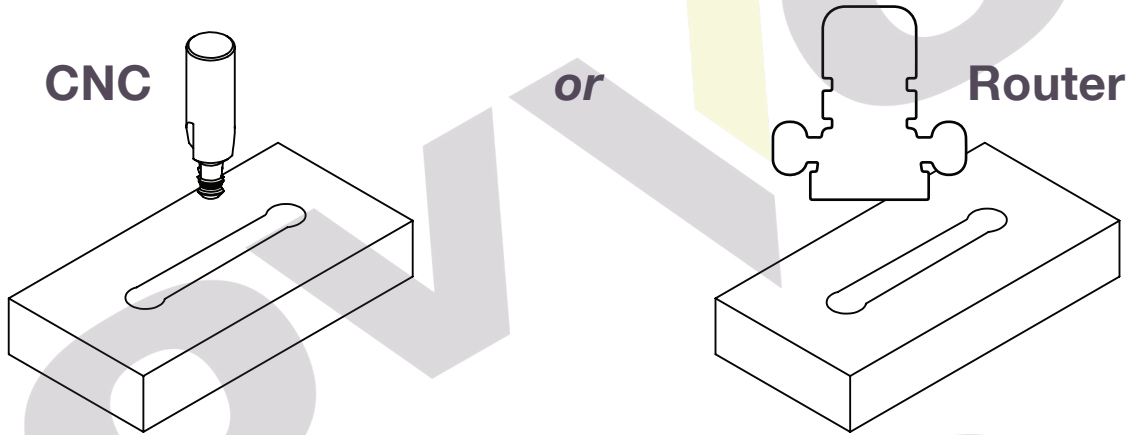

**2.** Cut in half

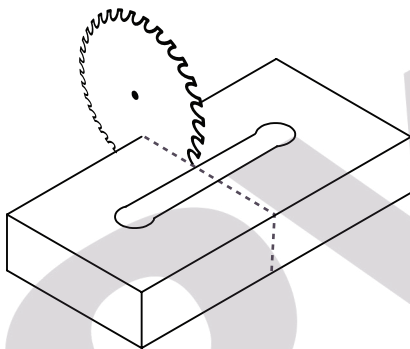

**3.** Insert Connection Set and check depth.

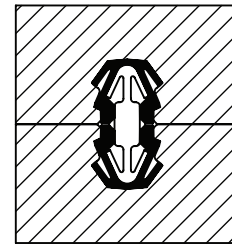

**X** Depth incorrect

Open joint?  
Increase depth.

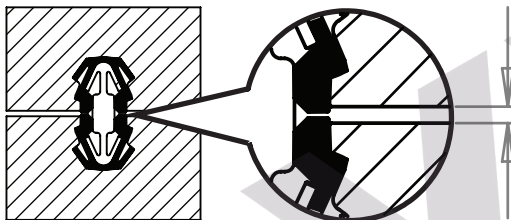

Wings not locking?  
Reduce depth.

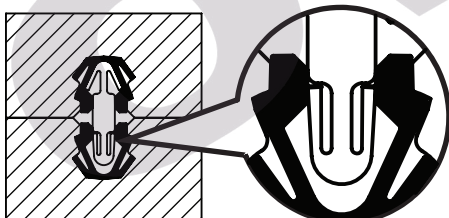

**✓** Depth correct

