

OVVO® V Connection System

V-0930 Permanent Specifications

V-0930 Permanent

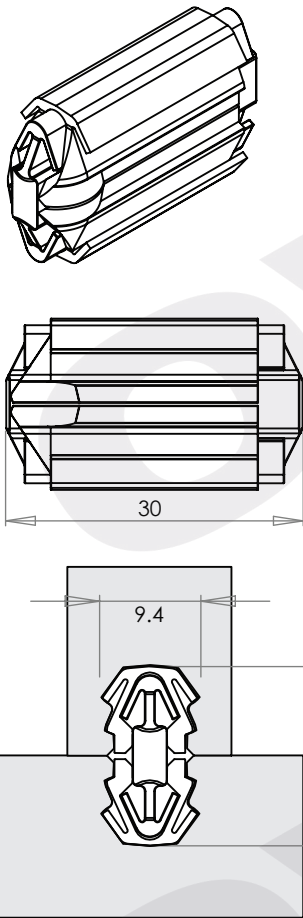

V-0930PH

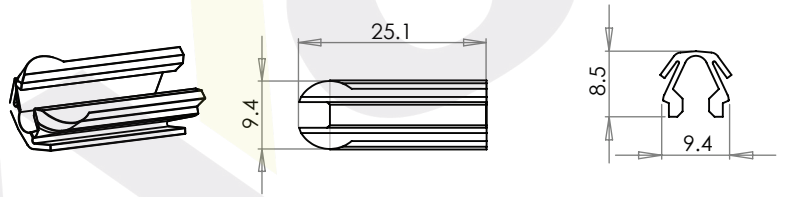

V-0930PC

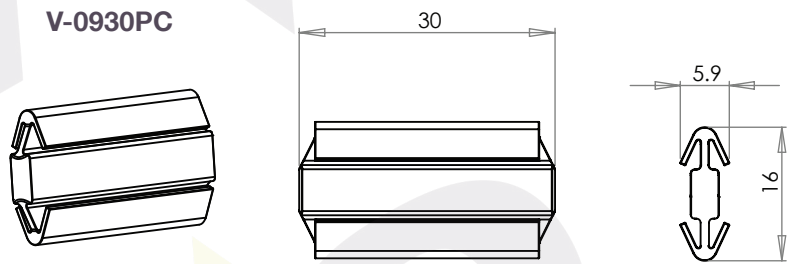

V-0930PH

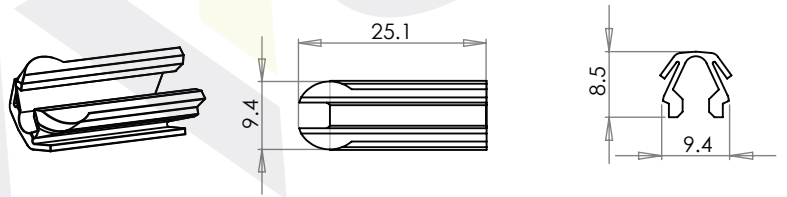

- (i) Plunge
- (ii) Travel
- (iii) Out

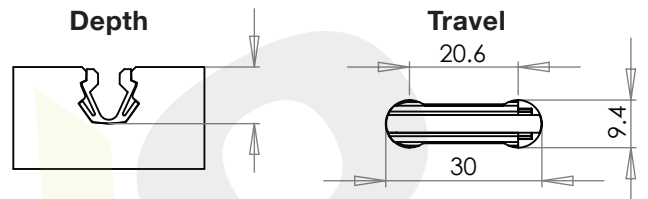
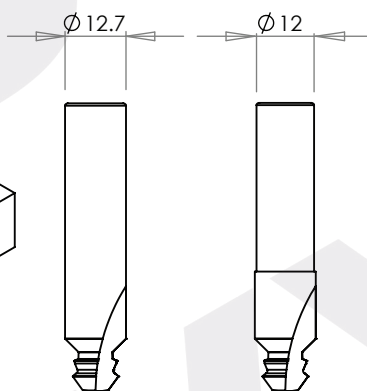
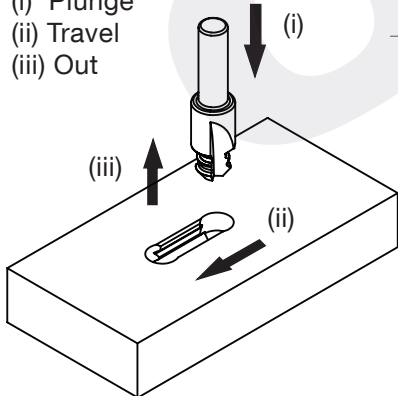

Depth Tolerances: 9.2mm (min) - 9.7mm (max)
Travel (Centre to Centre): 20.6mm
Out to Out: 30mm

*CNC speeds vary with different materials.
 Maximum cutter rotation: 18,000*

How it works

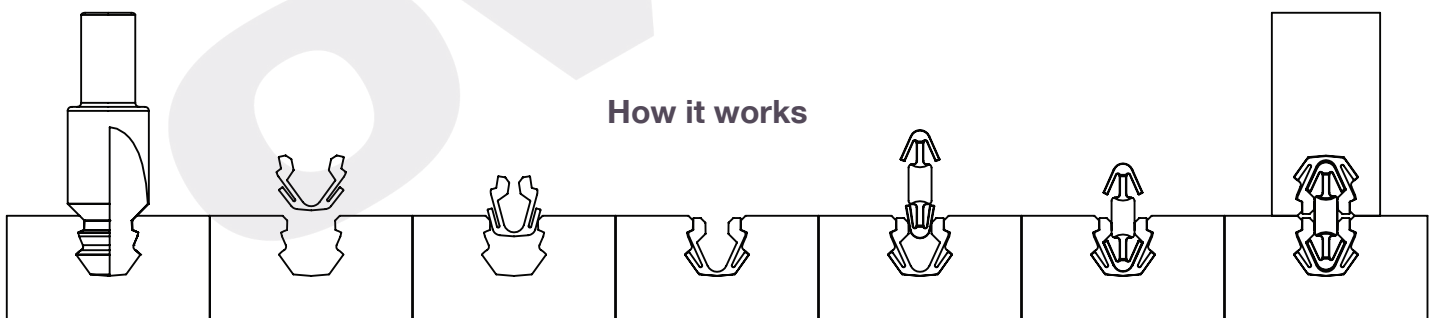

OVVO® V Connection System

V-0930 Releasable Specifications

THE FUTURE OF CONNECTION



V-0930 Releasable

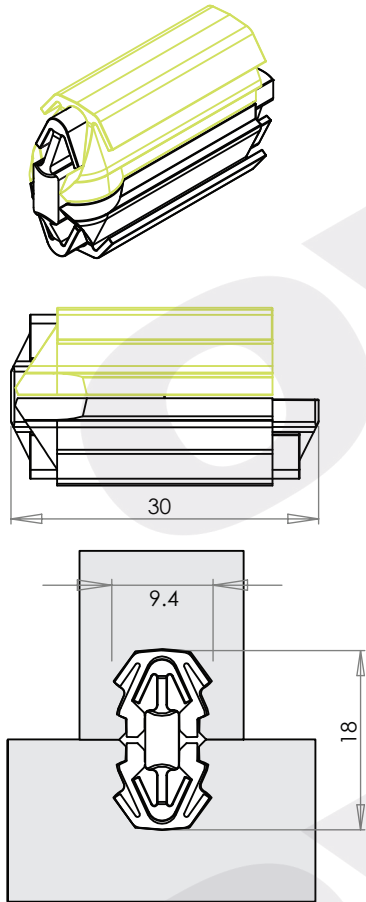

V-0930RH

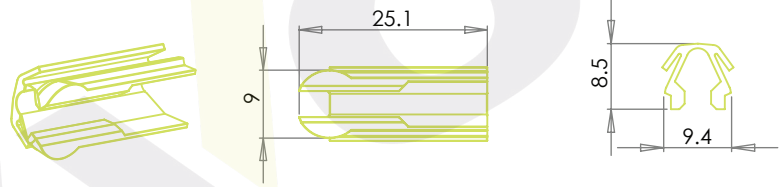

V-0930RC

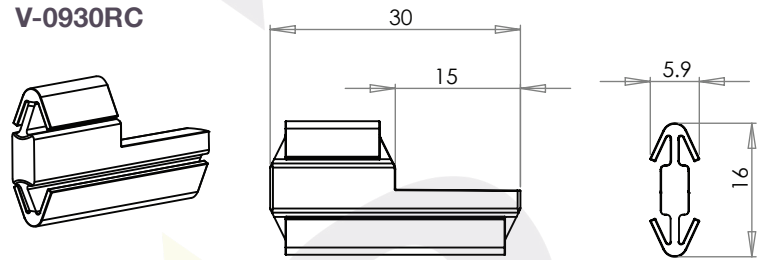

V-0930PH

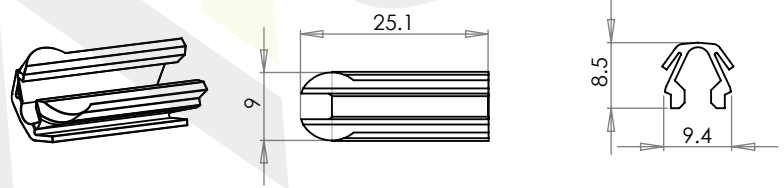

- (i) Plunge
- (ii) Travel
- (iii) Out

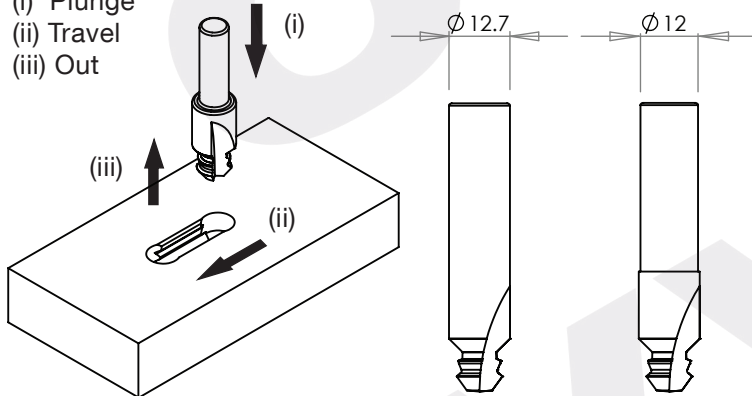

Depth

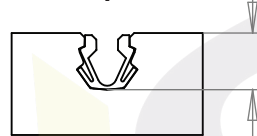

Travel

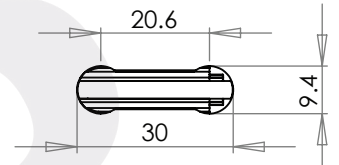

Depth Tolerances: 9.2mm (min) - 9.7mm (max)

Travel (Centre to Centre): 20.6mm

Out to Out: 30mm

*CNC speeds vary with different materials.
Maximum cutter rotation: 18,000*

How it works

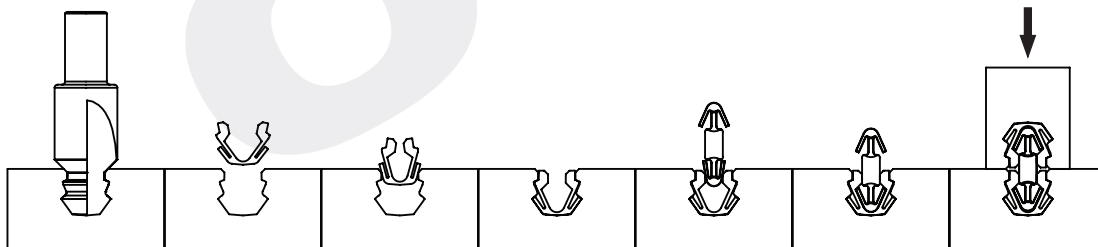

Simply push or slide to connect

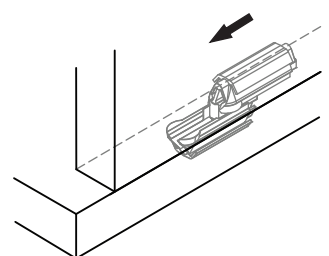

V-0930 Recommended Minimum Board Depth

Recommended minimum board depth or thickness values for the V-0930 will change depending on both the substrate material used as well as the joint angle.

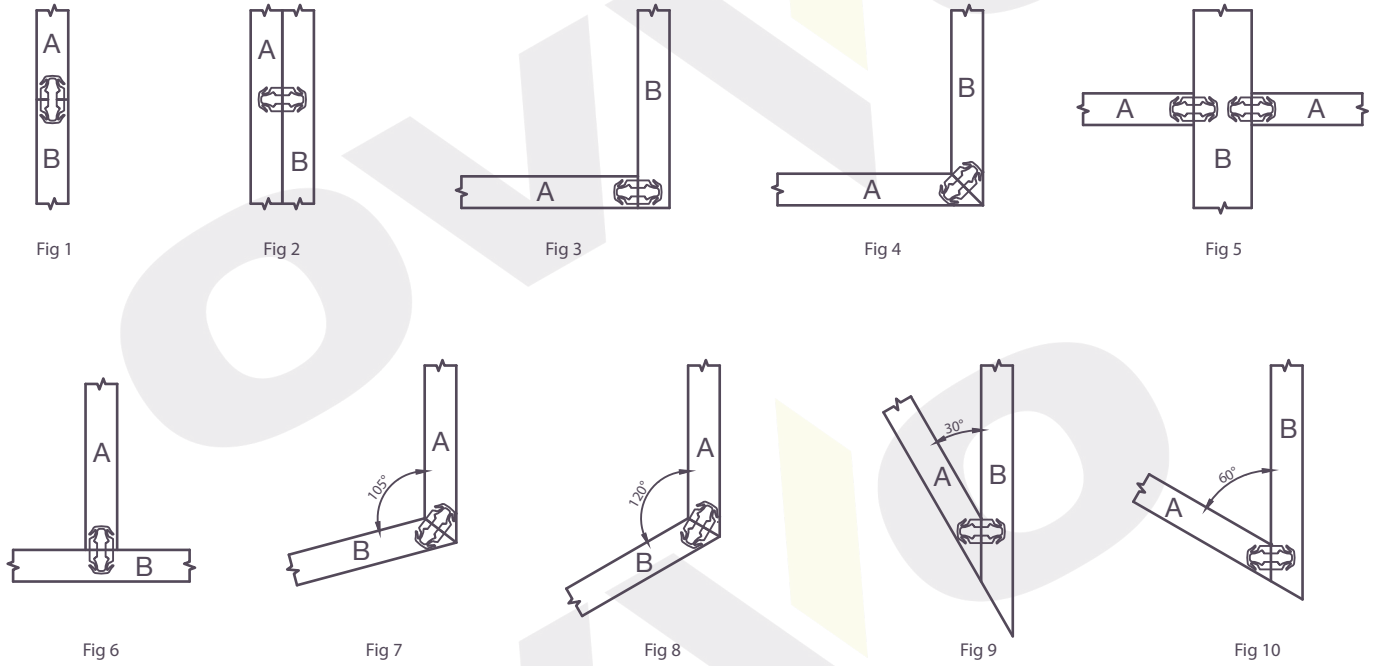

Minimum recommended measurements shown below are categorized according to two distinct groups of board material which share broadly similar connector retention properties.

	HPL, Composite, Solid Surface, Hardwoods, Birch Plywood	
	A	B
Fig 1	12mm	12mm
Fig 2	12mm	12mm
Fig 3	12mm	12mm
Fig 4	14mm	14mm
Fig 5	12mm	19mm
Fig 6	12mm	12mm
Fig 7	12mm	12mm
Fig 8	12mm	12mm
Fig 9	12mm	12mm
Fig 10	12mm	12mm

	Particle/Chipboard, Softwoods, MDF	
	A	B
Fig 1	15mm	15mm
Fig 2	12mm	12mm
Fig 3	16mm	12mm
Fig 4	15mm	15mm
Fig 5	15mm	19mm
Fig 6	15mm	12mm
Fig 7	15mm	15mm
Fig 8	15mm	15mm
Fig 9	15mm	15mm
Fig 10	15mm	15mm

These are guidelines only and OVVO® recommends trial connections be made before going into full production.

OVVO® V Connection System

V-0930 Shear & Tensile

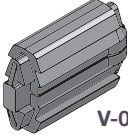
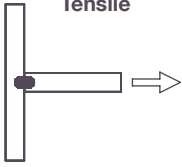
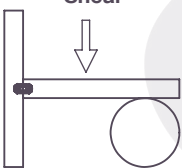
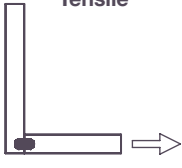
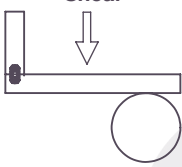
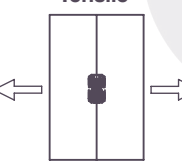
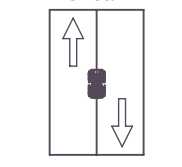
 V-0930	18mm Chipboard		18mm MDF		18mm Plywood		12mm Plywood		12mm HPL	
	Permanent	Releasable	Permanent	Releasable	Permanent	Releasable	Permanent	Releasable	Permanent	Releasable
Tensile  2 x V-0930 per test	65kg	52.5kg	67.5kg	42.5kg	140kg	82.5kg	75kg	57.5kg	-	-
Shear  2 x V-0930 per test	150kg	130kg	180kg	130kg	475kg	325kg	175kg	110kg	-	-
Tensile  2 x V-0930 per test	40kg	40kg	-	-	-	-	-	-	-	-
Shear  2 x V-0930 per test	85kg	85kg	-	-	-	-	-	-	-	-
Tensile  1 x V-0930 per test	50kg	30kg	50kg	35kg	-	-	85kg	45kg	100kg	50kg
Shear  1 x V-0930 per test	105kg	70kg	137.5kg	90kg	-	-	170kg	105kg	230kg	140kg



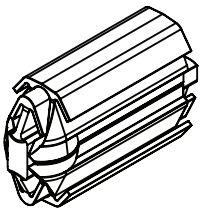

V-0930

Permanent Instructions

1. Milling

- (i) Plunge
- (ii) Travel
- (iii) Out

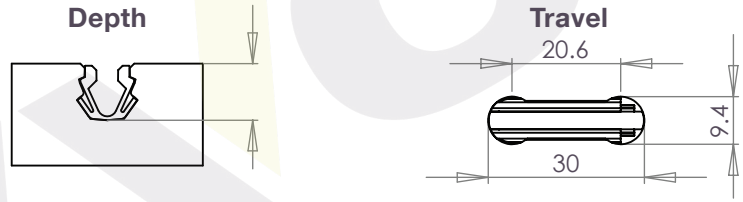
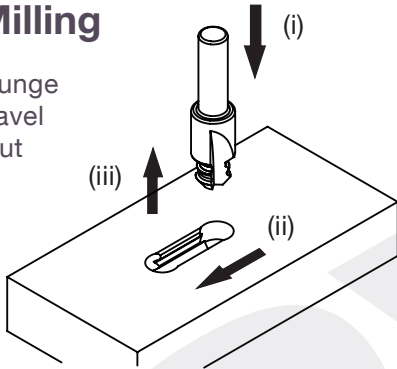

Depth Tolerances: 9.2mm (min) - 9.7mm (max)

Travel (Centre to Centre): 20.6mm

Out to Out: 30mm

CNC speeds vary with different materials. Maximum cutter rotation: 18,000

2. Housing

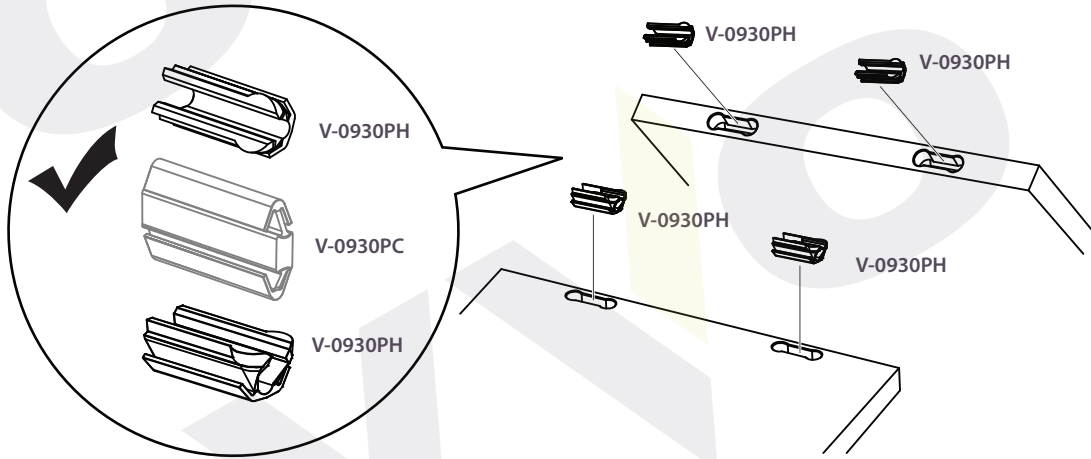

3. Assembly - Simply push into place to connect

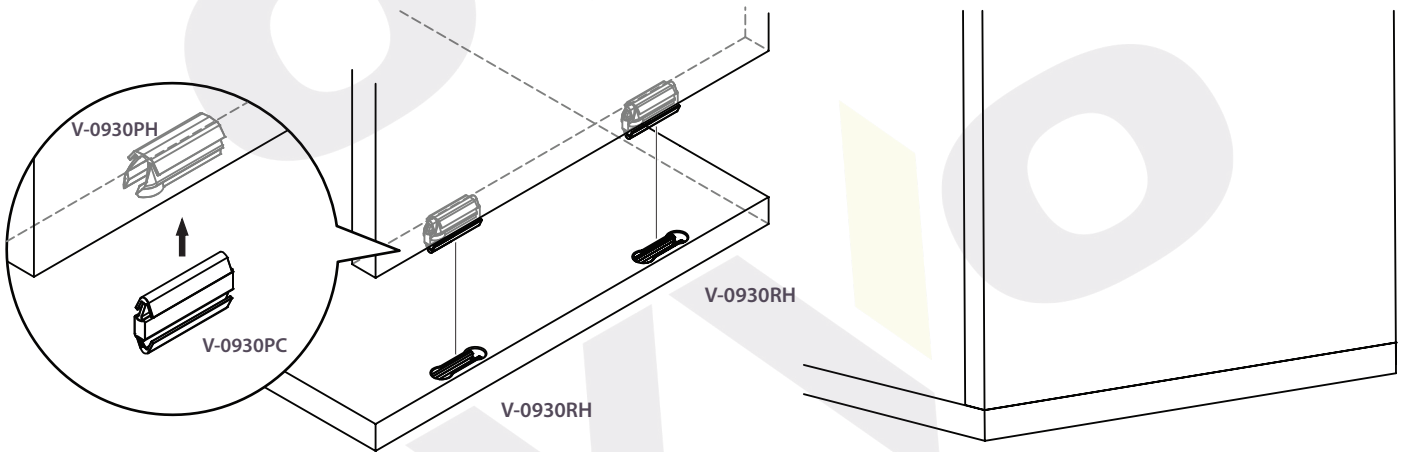

How it works

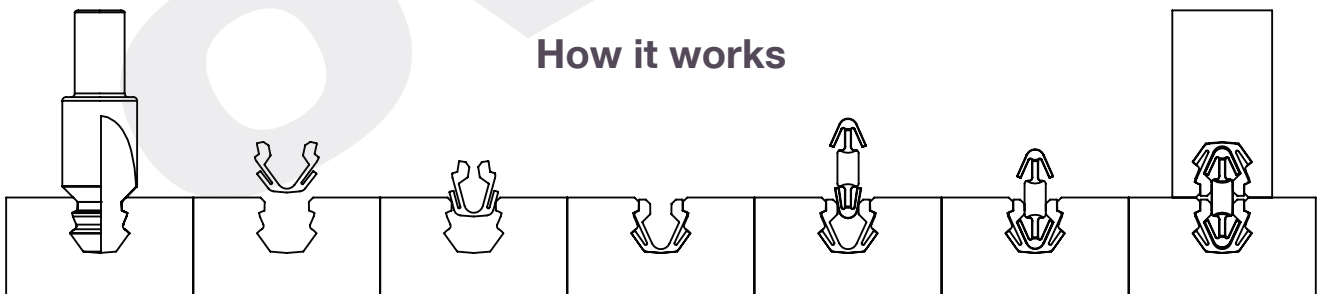

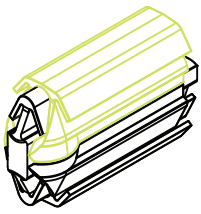

V-0930 Releasable Instructions

1. Milling

- (i) Plunge
- (ii) Travel
- (iii) Out

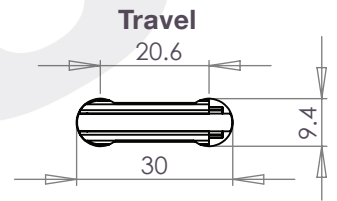
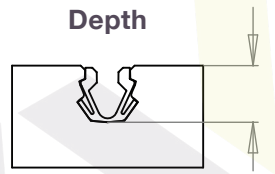
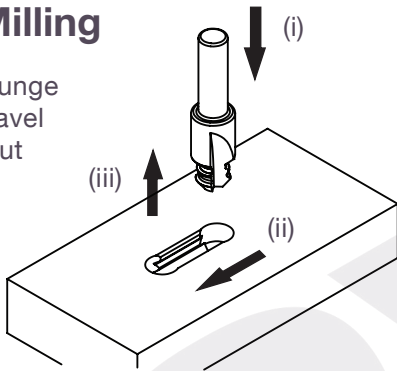

Depth Tolerances: 9.2mm (min) - 9.7mm (max)

Travel (Centre to Centre): 20.6mm

Out to Out: 30mm

CNC speeds vary with different materials. Maximum cutter rotation: 18,000

2. Housing

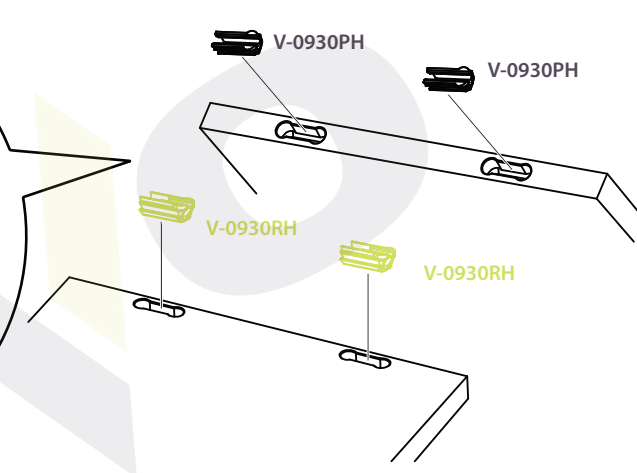
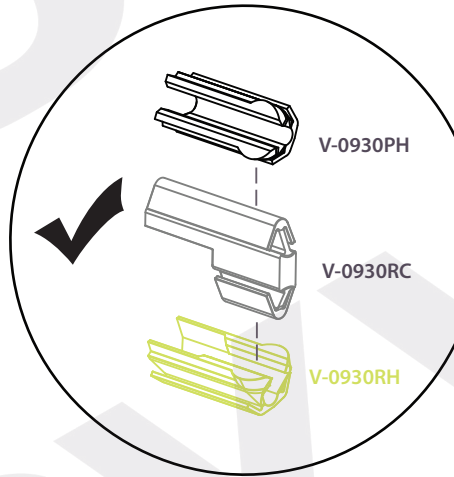

3. Assembly - Simply push or slide to connect

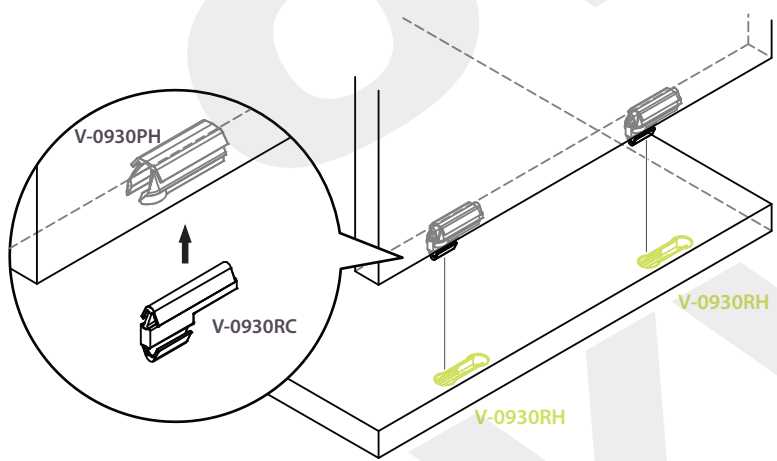

4. Release

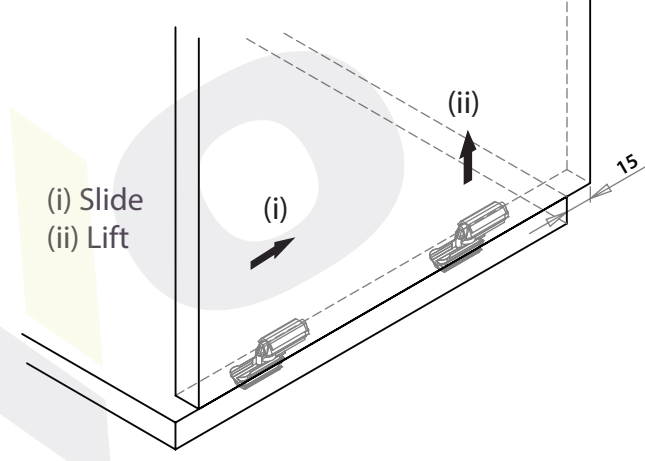

How it works

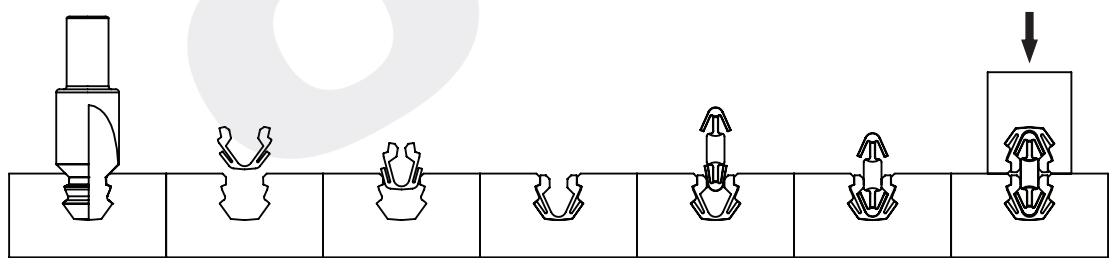

Simply push or slide to connect

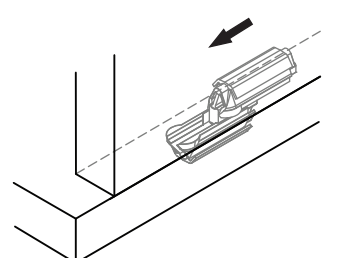

OVVO® V Connection System

Important! Make a test

THE FUTURE OF CONNECTION



IMPORTANT! MAKE A TEST
WICHTIG! MACHEN SIE EINEN TEST
IMPORTANT! FAIRE UN TEST
IMPORTANTE! FARE UN TEST
IMPORTANTE! HACER UNA PRUEBA

DEPTH TOLERANCES	
V-0930	9.2mm (min) - 9.7mm (max)

